

Modulus Pedestal Base

Typical Assembly Details



freeway

Components	Qty	Part No.
1. Steel Plate	x1	MODZAPLATE
2. Feet tube Ø 51	x1	MODZA22G95P
3. Large foot	x4	MODZA12
4. Cross Collar	x1	MODZA01
5. Foot Glide	x4	MODZA25
6. Cross Gasket	x1	MODZA26
7. Table Top	x1	

Screws

8. M5*20 Self tapping	x8
9. M8*16	x4
10. M10*110	x1
11. M8*30	x30
12. M6 Allen Key	x1
13. M10 Machine Drill	x1

1.

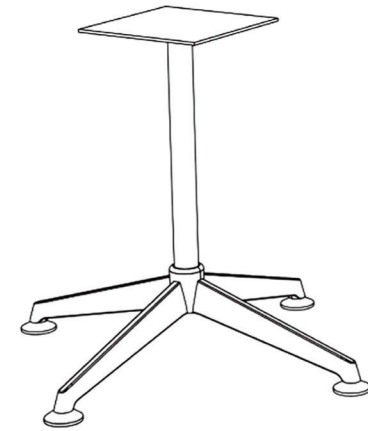
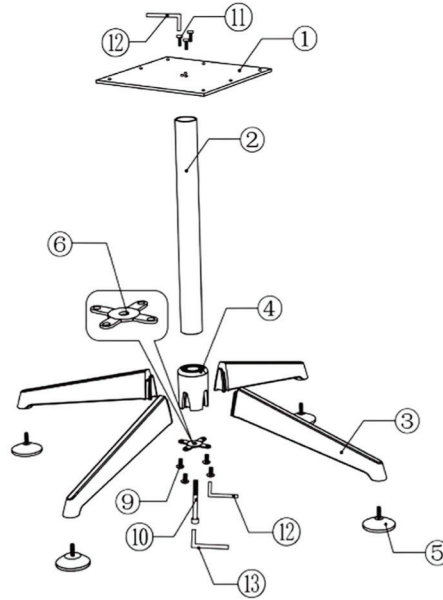

2.



3.



Modulus Twin Post Base

Typical Assembly Details



freeway

Components	Qty	Part No.
1. Die Cast Upper Wrist	x6	MODZA06
2. Top Rail		FWTOPRAIL
3. Bottom Rail		FWBOTRAIL
4. Feet Tube Ø51	x6	MODZA22-695
5. Large Foot	x6	MODZA12
6. 150° Collar	x4	MODZA02
7. Cross Collar	x2	MODZA01
8. Bottom Tee Connector	x2	MODZA07
9. Cross Connector	x4	MODZA08
10. Collar Plug	x4	MODZA15
11. Tee Connector	x6	MODZA09
12. Minus Gasket	x2	MODZA27
13. 150° Gasket	x4	MODZA28
14. Foot Glide	x6	MODZA25
15. Top Rail Cap	x4	MODZA18
16. Pole Strap	x3	AU-FW...SET
17. Plastic Support	x8	MODZA16
18. Table Top	x2	
Screws		
20. M8*16	x28	
21. M10*110	x6	
22. M10*3020.	x6	
23. M8*25	x6	
24. M5*30 Self tapping	x12	
25. M5*20	x47	
26. 6mm Machine Drill	x1	
27. 8mm Machine Drill	x1	
28. 10mm Machine Drill	x1	

1.

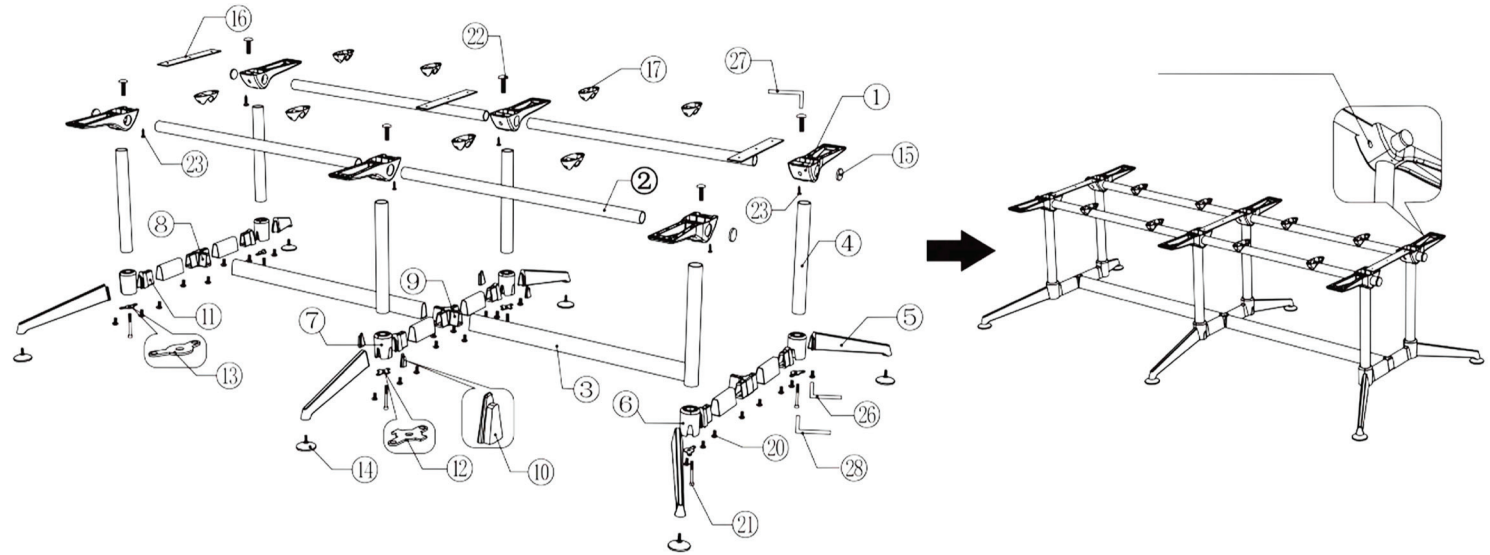

2.

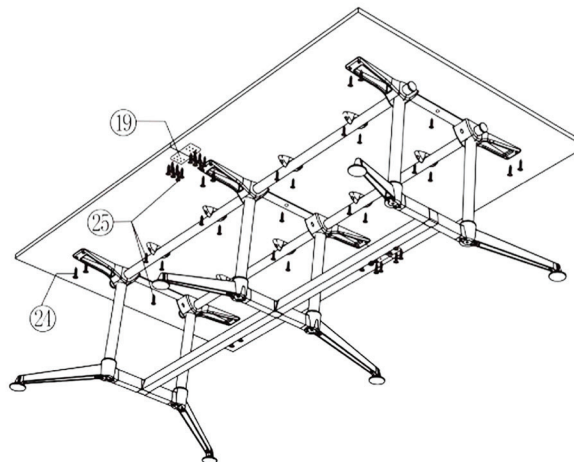

3.

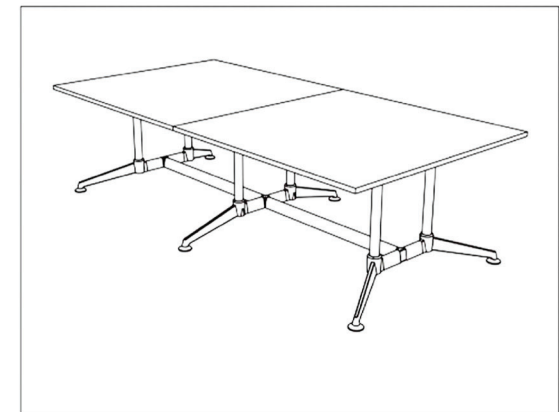

Modulus Multi Post Pedestal Base

Typical Assembly Details



freeway

Components	Qty	Part No.
1. Die Cast Upper Wrist	x6	MODZA06
2. Steel Strap	x2	MODZAST11.2
3. T - Tube	x4	MODZASET11.2
4. Feet Tube Ø51	x4	MODZA22-695
5. Large Foot	x4	MODZA12
6. Cross Collar	x4	MODZA01
7. Cross Connector	x1	MODZA08
8. T-Tube + Collar Connector	x4	MODZA09
9. Cross Collar Plug	x8	MODZA15
10. Minus Gasket	x4	MODZA27
11. Foot Glide	x4	MODZA25
12. Table Top	x1	

Screws

13. M8*16	x16
14. M10*110	x4
15. M6*25	x4
16. M5*20 Self tapping	x12
17. 6mm Machine Drill	x1
18. 8mm Machine Drill	x1
19. 10mm Machine Drill	x1

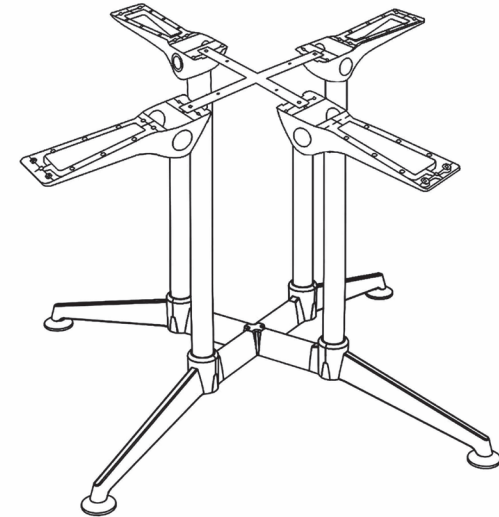
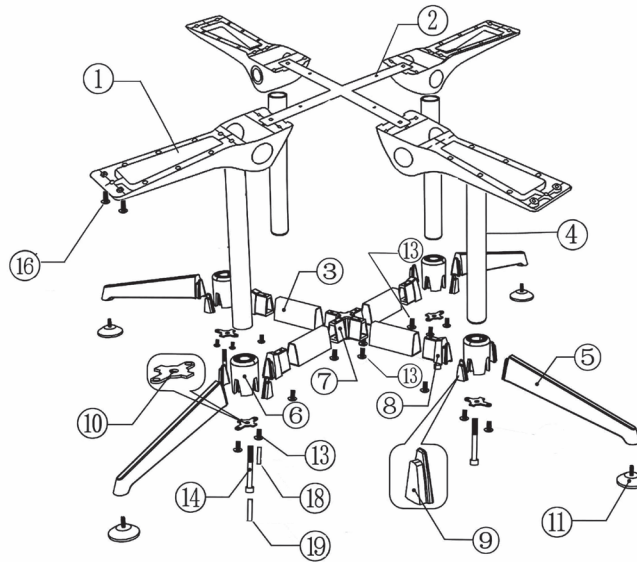

2.

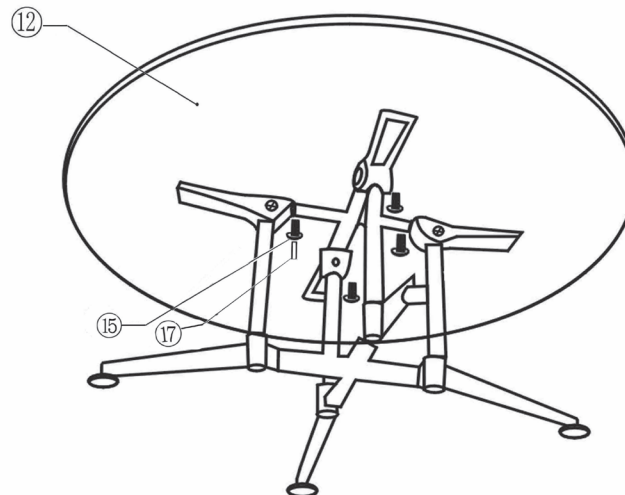

3.

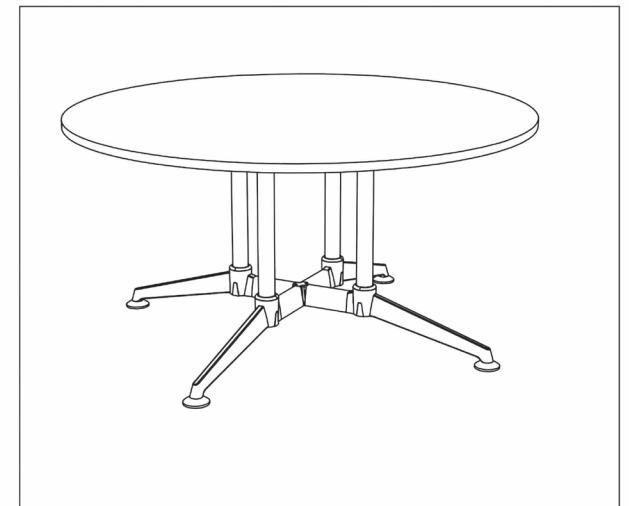

Modulus Fixed Leg Base

Typical Assembly Details



freeway

Components	Qty	Part No.
1. Die Cast Upper Wrist	x2	MODZA06
2. Top Rail x1	x1	FWTOPRAIL
3. Leg - Tube Ø51	x2	MODZA22-695
4. Fixed Foot	x2	MODZA
5. Foot Glide	x4	MODZA25
6. Top Rail Plastic Plug	x2	MODZA18
7. Plastic Support	x1	MODZA16
8. Table Top	x1	

Screws

9. M10*30	x2
10. M10*65	x2
11. M4*20 Self tapping	x2
12. M5*25 Self tapping	x8
13. M8*16	x4
14. 4mm Allen Key	x1
15. 5mm Machine Drill	x1
16. 8mm Machine Drill	x1
17. 10mm Machine Drill	x1

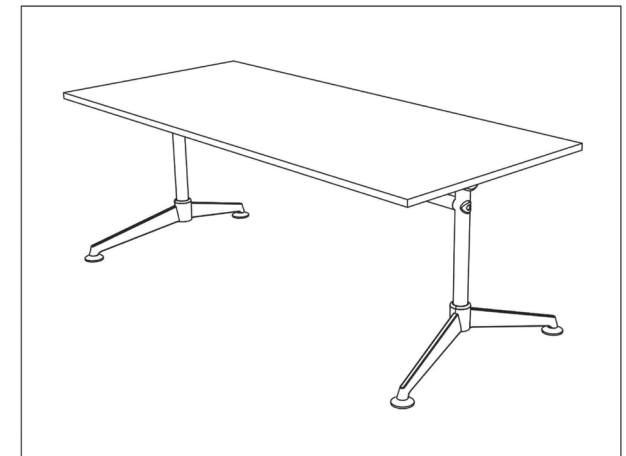
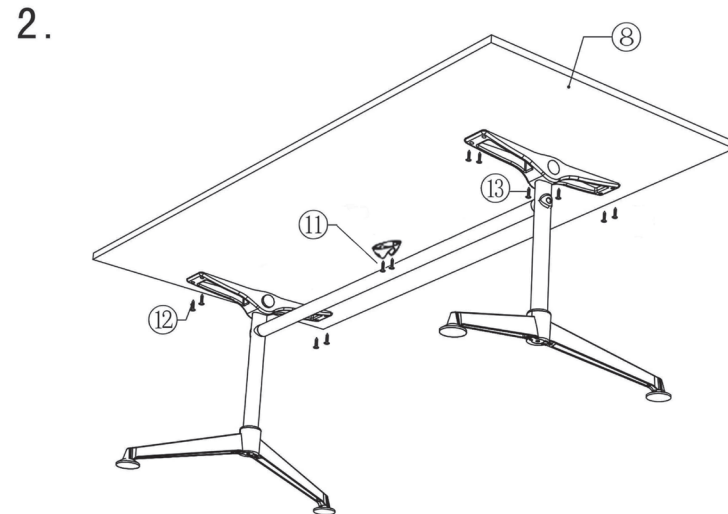
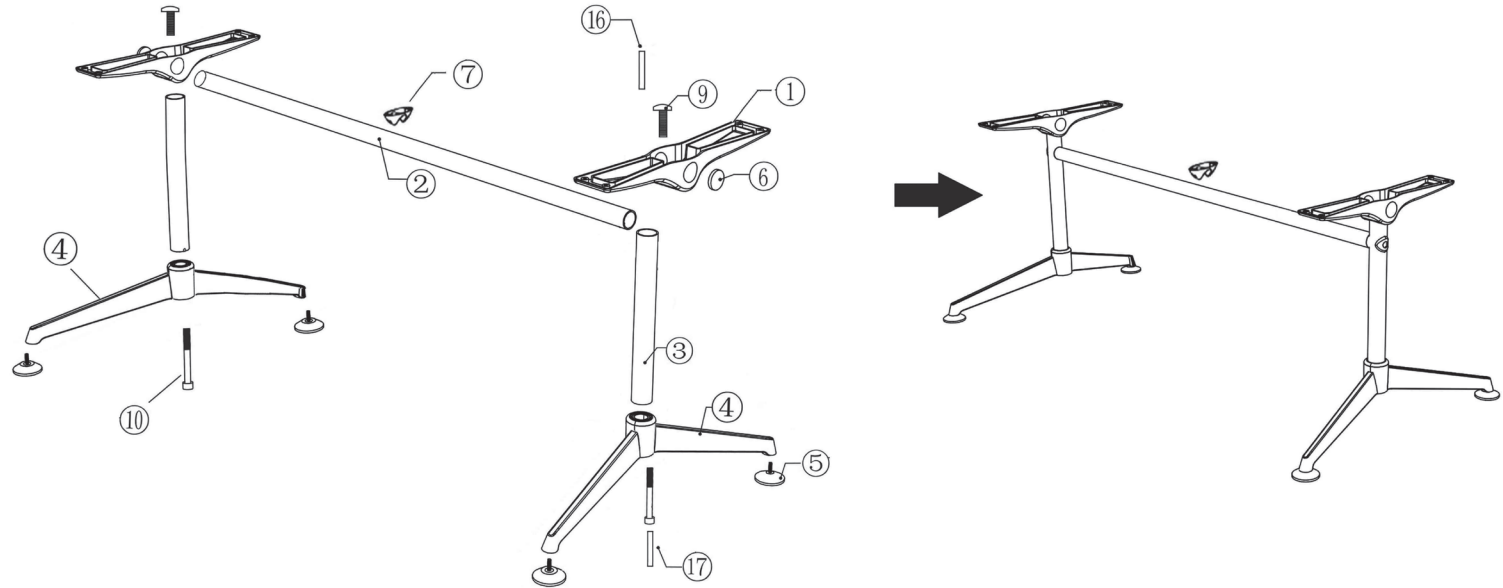

Modulus Collar Leg Table with Power Pole Upgrade

Installation Guide

TOOLS REQUIRED: Powered screwdriver.

Modulus Single Post Pedestal Table

INSTALLATION GUIDE

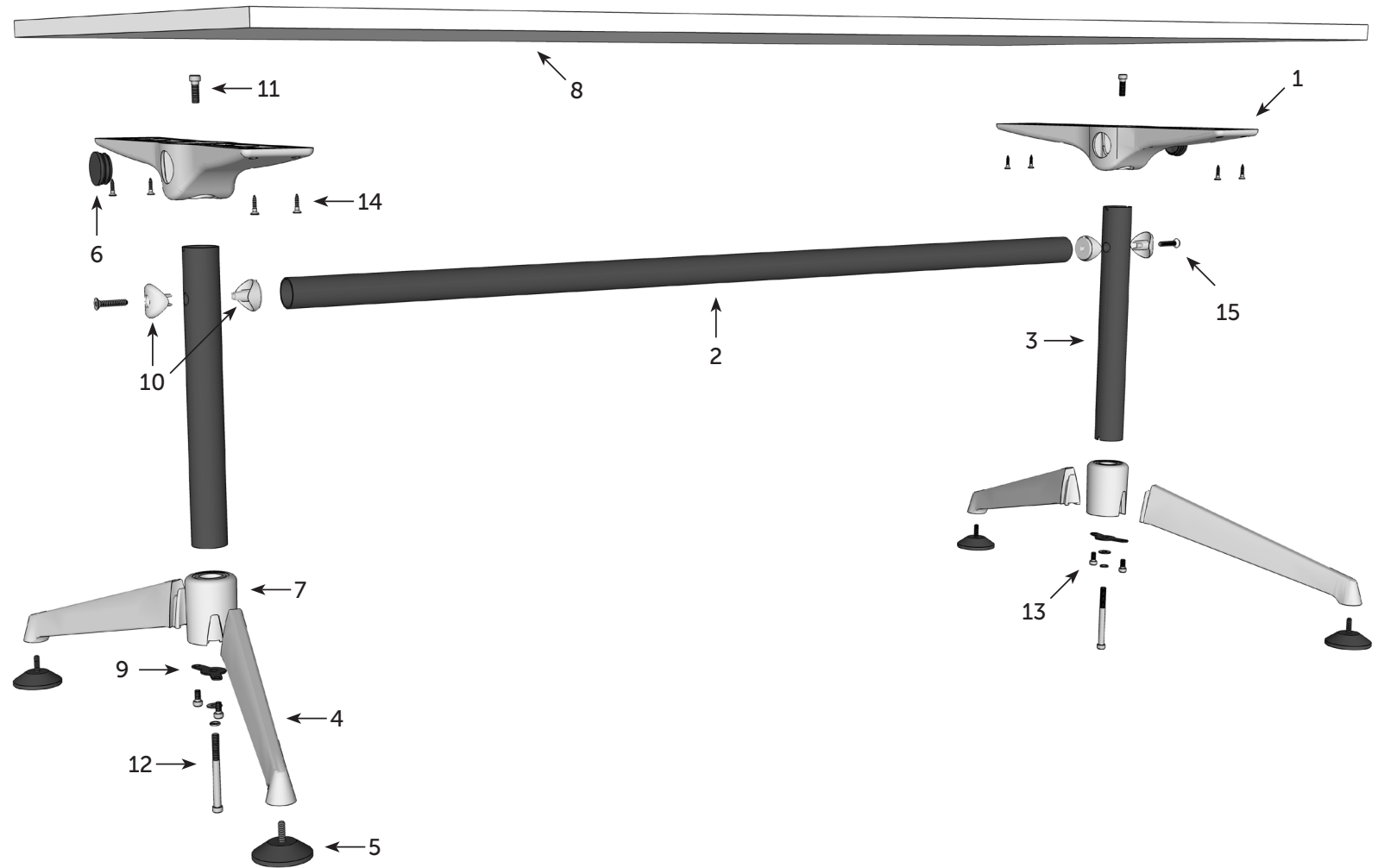

COMPONENTS

- 1 Upper Wrist x2
- 2 Top Rail x1
- 3 Leg Tube x2
- 4 Large Foot x4
- 5 Foot Glide x4
- 6 Top Rail Cap x2
- 7 150° Collar x2
- 8 Table Top x1
- 9 150° Gasket x2
- 10 Power Pole Bracket x2

SCREWS

- 11 M10x30mm x2
- 12 M10x110mm x2
- 13 M8x16mm x4
- 14 M5x25mm Self Tapping x8
- 15 M8x80mm x2

Modulus Single Post Pedestal Table



INSTALLATION GUIDE

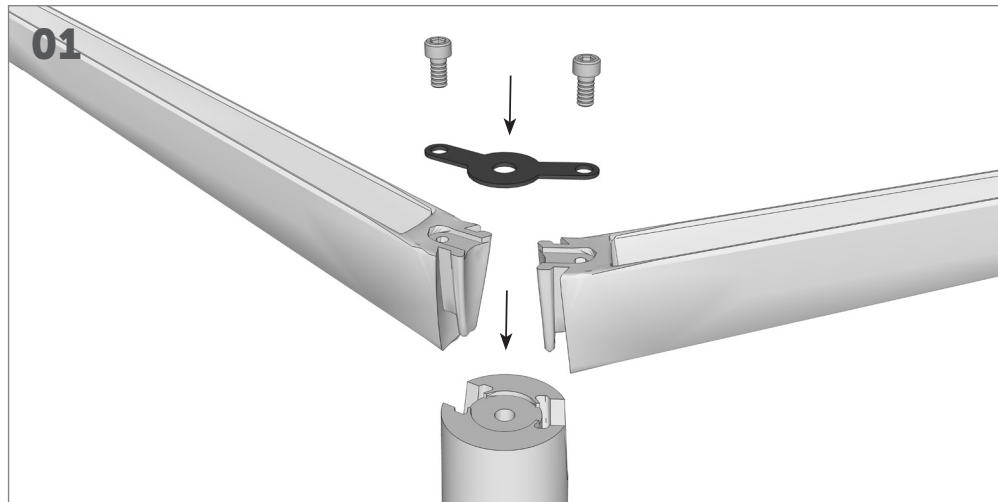

01 Slide 2 large feet into the collar, place the 150° gasket on top and fully tighten the 2 M8x16mm bolts into the collar. (Repeat with all collars).



02 Screw all glides into the base of the large feet, leaving the glides one turn from tight (then they can be adjusted easily if the floor is uneven).



03 Place the feet tube on top of each collar, and the upper wrist on top of the feet tubes. Fully tighten the M10x30mm bolts through the upper wrists, and M10x110 bolt, spring washer and flat washer through the collars.

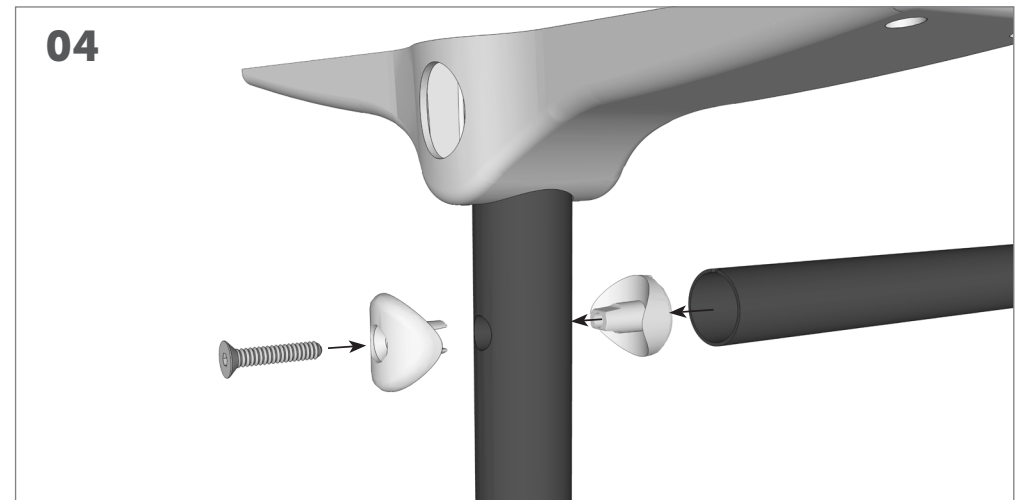

04 Place each assembled leg set together using the rail, and fully tighten the M8x80mm bolts through the bracket into the rail.

Modulus Single Post Pedestal Table



INSTALLATION GUIDE

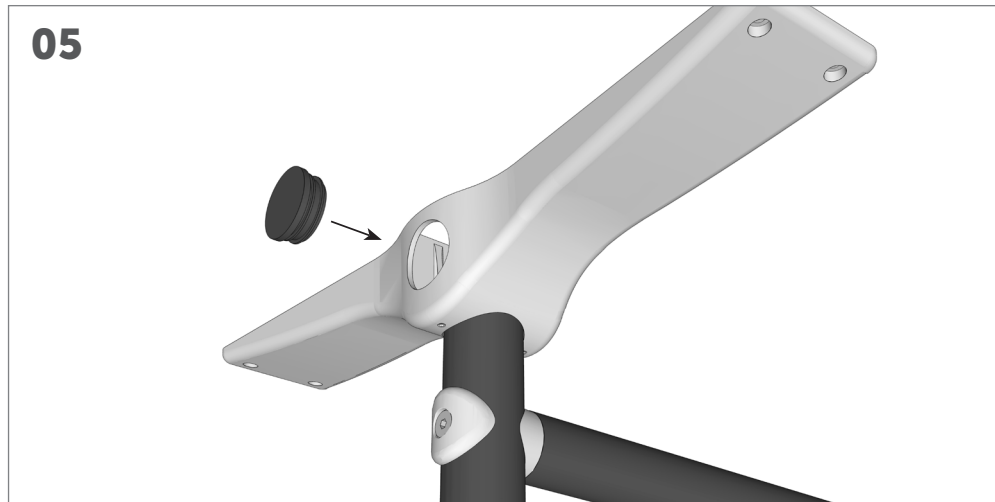

Place the top rail cap into the exposed side of the upper wrist.

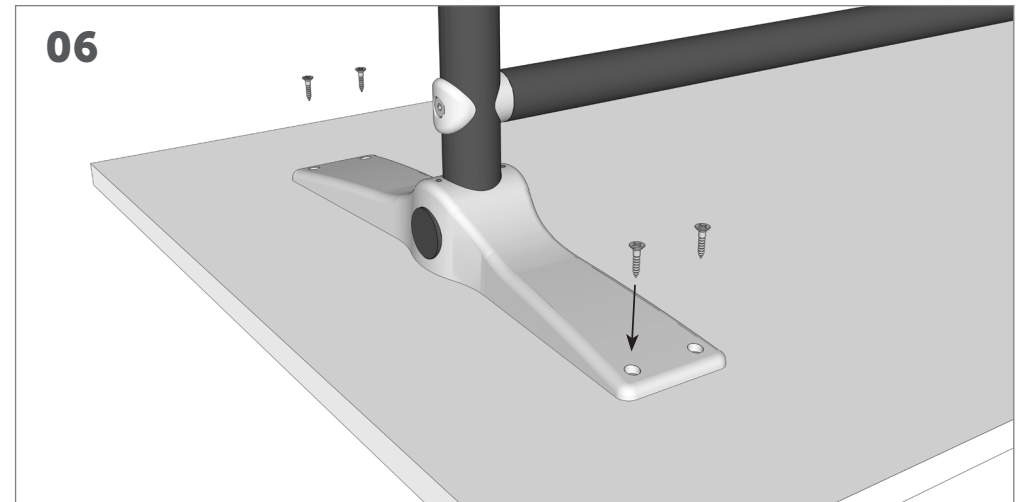

With the frame assembly complete, locate it in the centre of the work surface and screw the remaining self tapping screws into each upper wrist.



Leftover components:

Pullbar 20mmØ x1
Leg Tube 45mmØ x2

Modulus Flip with Modesty Panel

Installation Guide

TOOLS REQUIRED: Powered screwdriver



MODULUS FLIP TABLE WITH MODESTY PANEL

Installation Guide

* To prevent possible scratches or damage, assemble the Desk upside down on a soft surface such as a blanket, carpet or packaging.

* Attach modesty panel to the frame and worksurface using bolts, screws and brackets provided. Tighten using Allen Key (or battery drill).

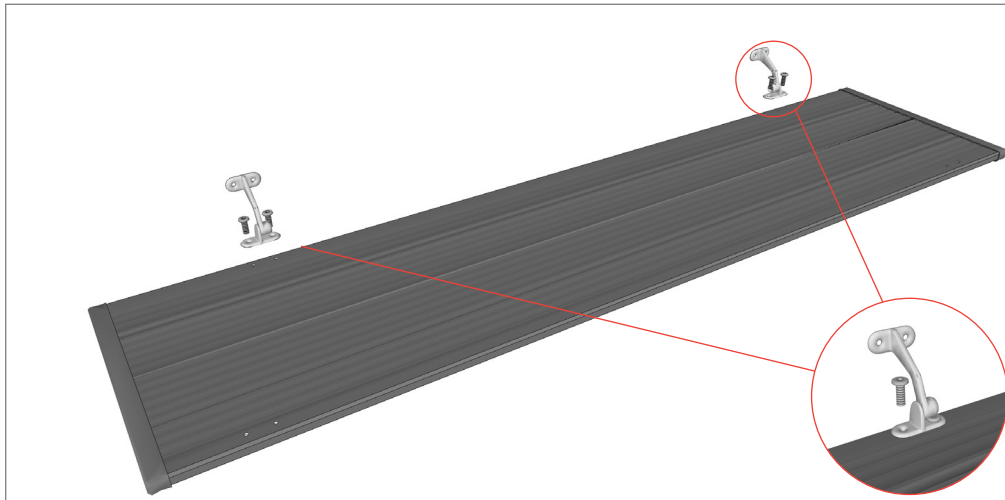

STEP 1: Lay modesty panel on flat surface, fasten brackets to modesty with threaded bolts provided.

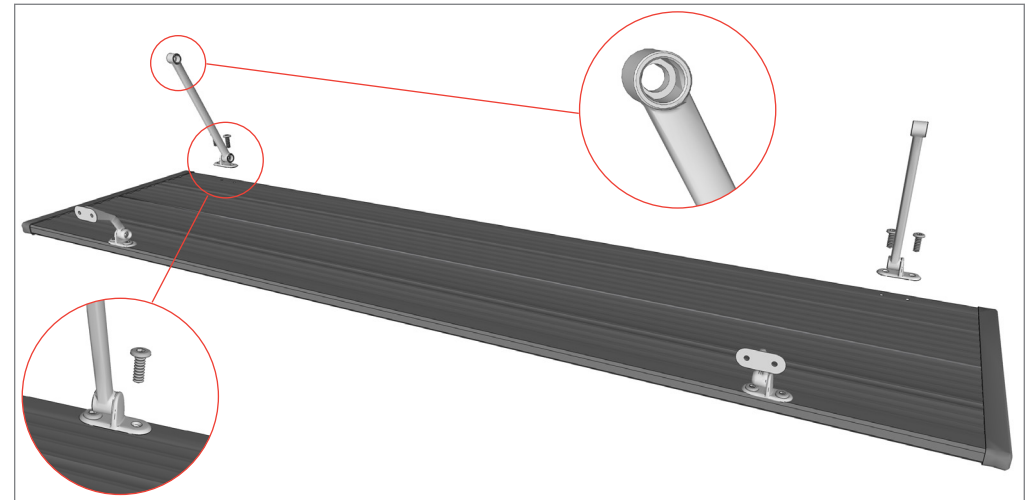

STEP 2: Fasten lever arms onto modesty with threaded bolts.
Note: LH & RH arms, countersunk side faces towards middle and flush side towards ends.

MODULUS FLIP TABLE WITH MODESTY PANEL

Installation Guide

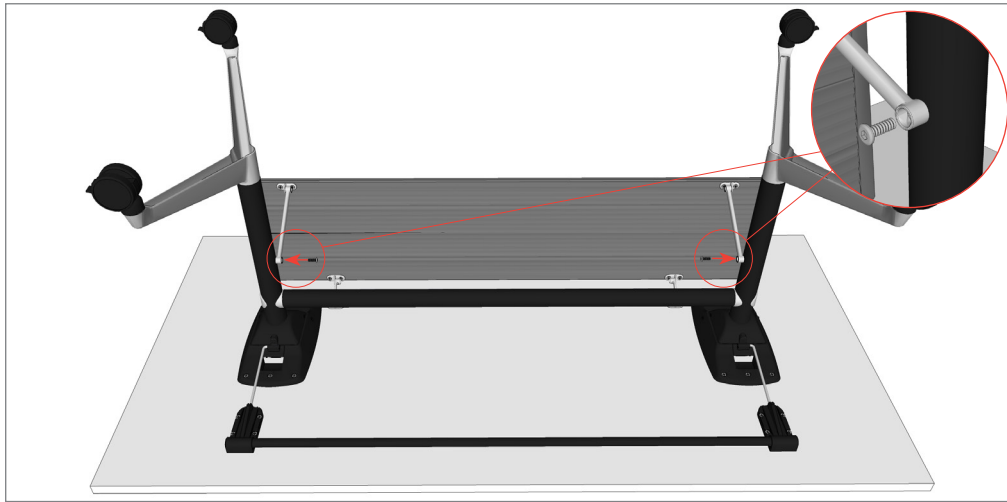

STEP 3: Position modesty on worktop (table upsidedown), attach lever arms onto frame, fully tighten bolts.

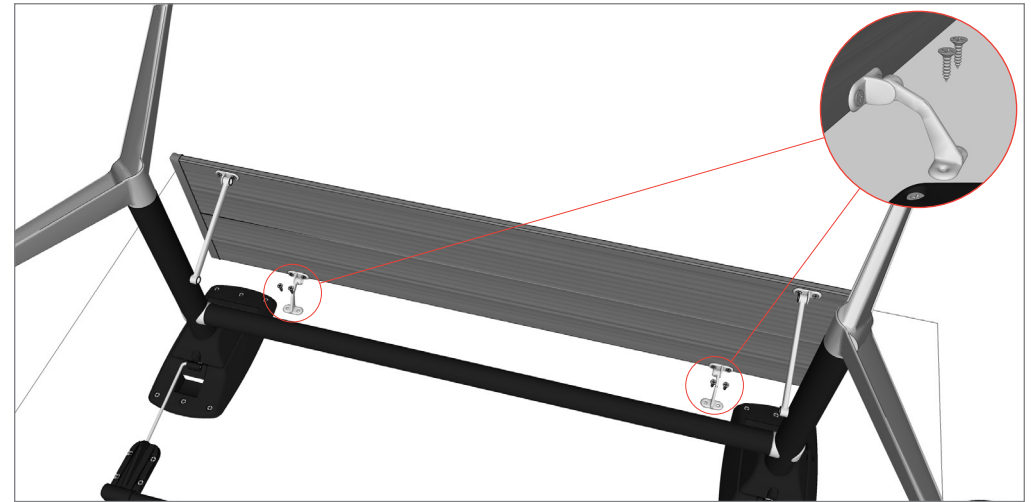

STEP 4: Hold the panel perpendicular to the worksurface and drill the self tapping screws into the worktop.



Complete

Modulus Fixed Leg Table

Installation Guide

TOOLS REQUIRED: Powered screwdriver.

Modulus Single Post Pedestal Table



INSTALLATION GUIDE

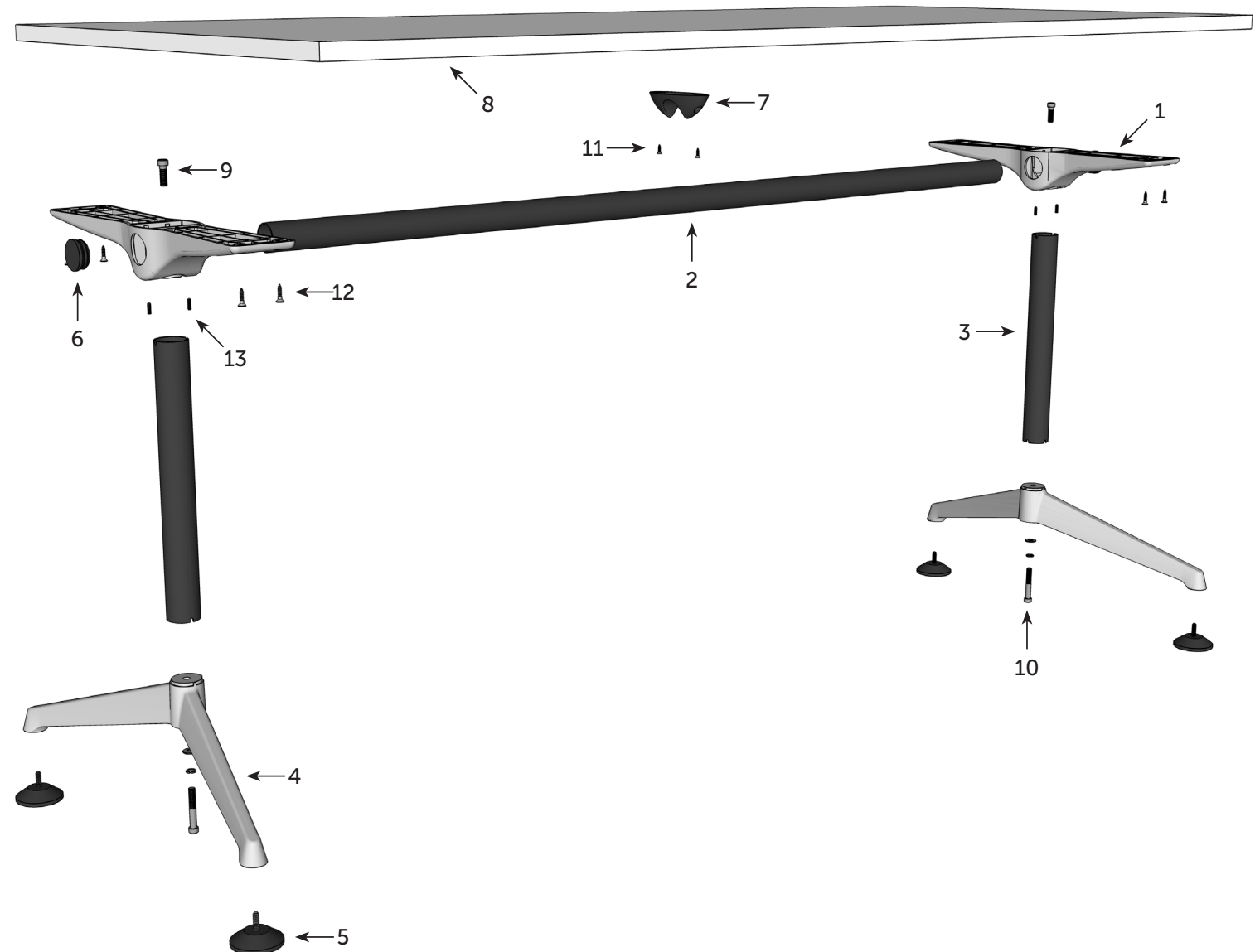

COMPONENTS

- 1 Upper Wrist x2
- 2 Top Rail x1
- 3 Leg Tube x2
- 4 Fixed Foot x2
- 5 Foot Glide x4
- 6 Top Rail Cap x2
- 7 Plastic Support x1
- 8 Table Top x1

SCREWS

- 9 M10x30mm x2
- 10 M10x65mm x2
- 11 M4x20mm Self Tapping x2
- 12 M5x25mm Self Tapping x8
- 13 M8x16mm x4

Modulus Single Post Pedestal Table



INSTALLATION GUIDE

01

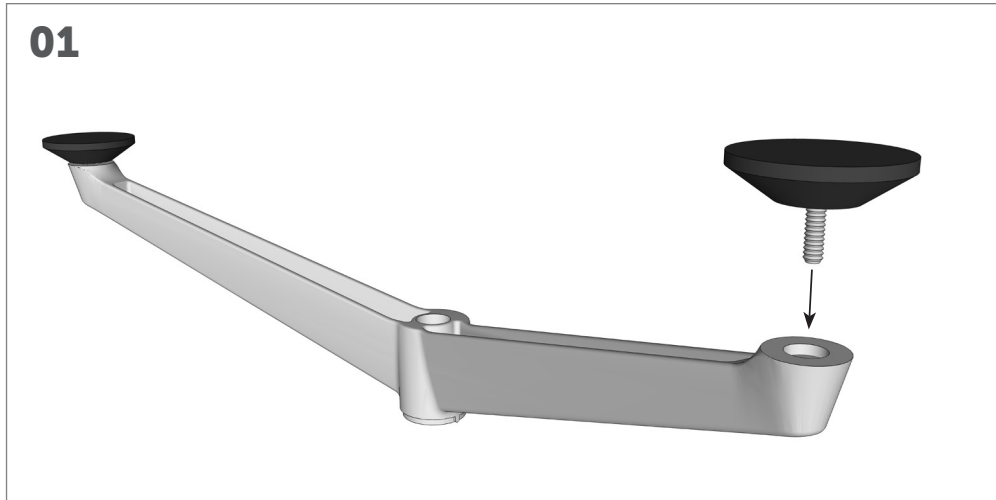

Screw the glides into the base of the fixed feet, leaving the glides one turn from tight (then they can be adjusted easily if the floor is uneven).

02

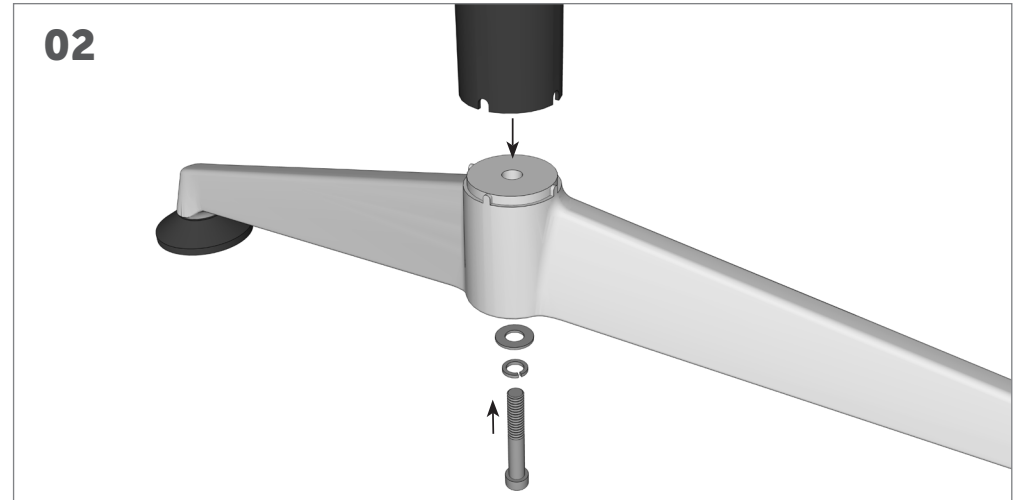

Place the leg tube on top of the fixed foot, making sure each small notch in the bottom of the leg tube is in-line with the bumps on the top of the fixed foot. Fully tighten to maximum tension the large M10x65mm bolts with spring and flat washer.

03

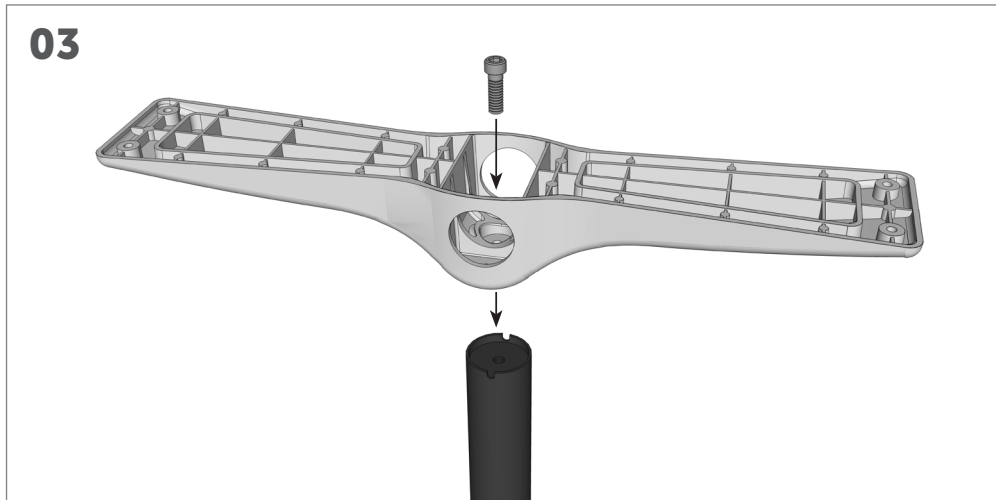

Place the upper wrist on top of the leg tube, making sure each small notch in the top of the leg tube is in-line with the bumps on the bottom of the upper wrist. Fully tighten to maximum tension the M10x30mm bolts.

04



With the legs assembled, place each end of the top rail into the holes on the side of the upper wrist, making sure they stop before going all the way through.

Modulus Single Post Pedestal Table

INSTALLATION GUIDE

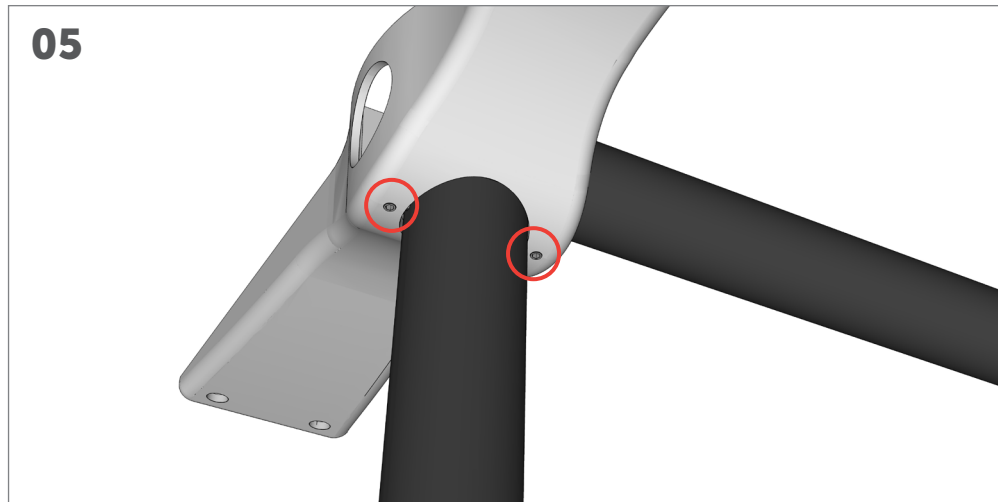

05
Fully tighten the small screws located at the bottom of each upper wrist to firmly hold the top rail in place.

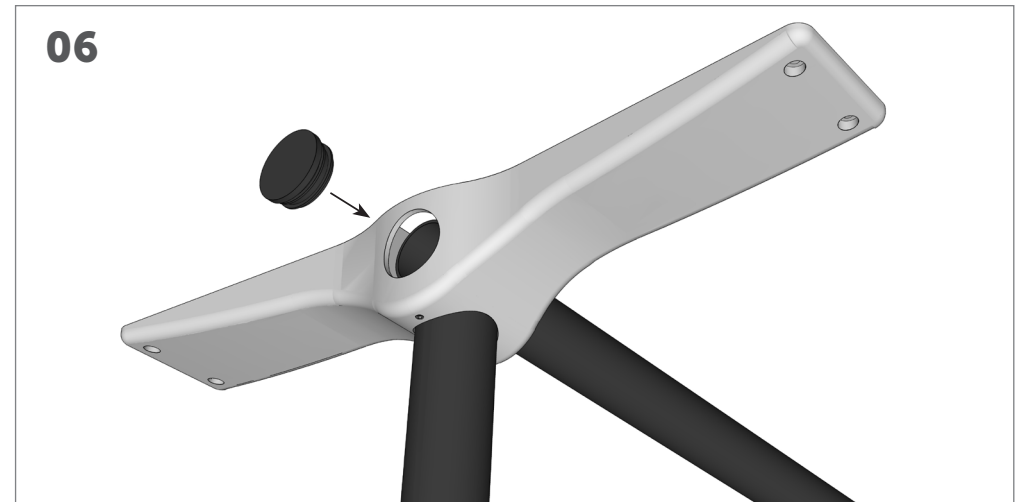

06
Place the top rail cap into the exposed side of the upper wrist.



07
Locate the plastic support bracket over the centre of the top rail, and click into place.

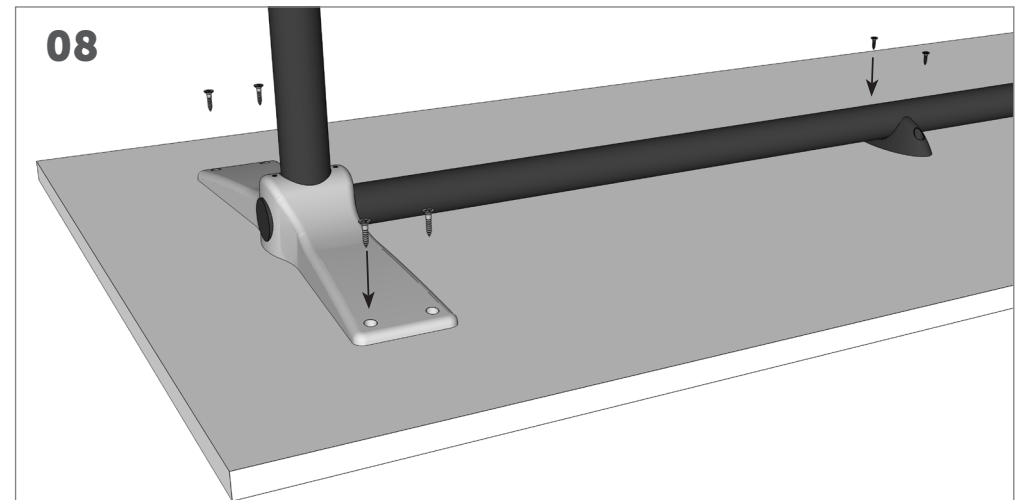

08
With the frame assembly complete, locate it in the centre of the work surface and screw the remaining self tapping screws into each upper wrist and plastic support.

Modulus Single Post Pedestal Table

INSTALLATION GUIDE



Modulus Flip Table

Installation Guide

TOOLS REQUIRED: Powered screwdriver



MODULUS FILP TABLE

Installation Guide

* To prevent possible scratches or damage, assemble the table upside down on a soft surface such as a blanket, carpet or packaging.



* Attach Leg to the Top assembly by using Bolts, spring washer, flat washer. Tighten using the Allen Wrench provided.

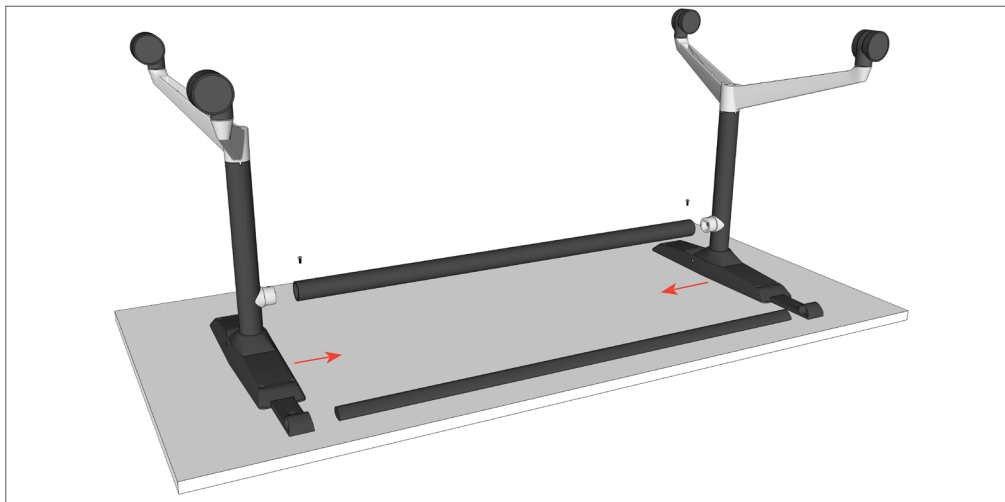
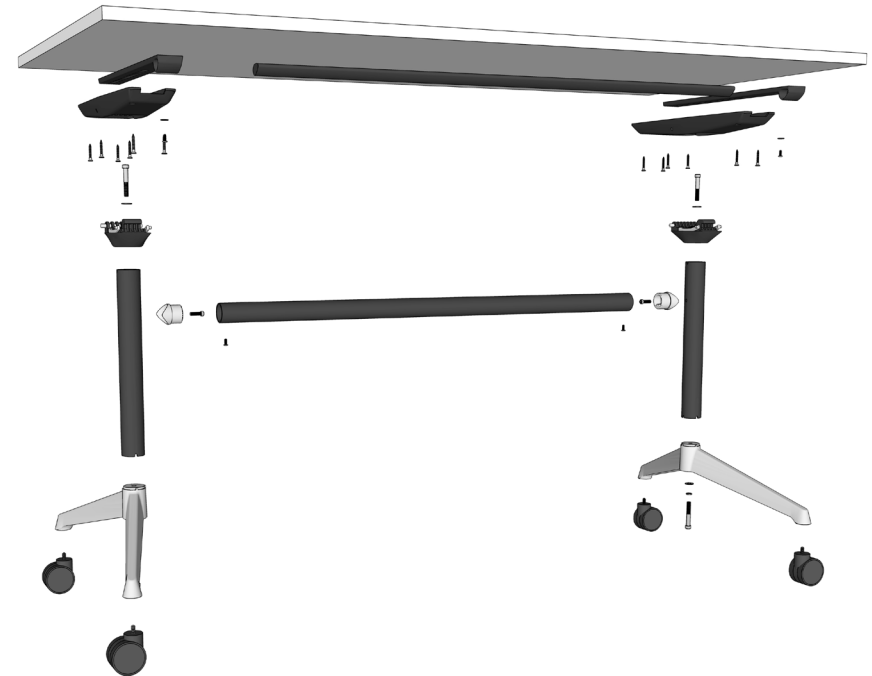

STEP 1: Place the pull bar (a) and cross tube (b) in the correct location pictured above, slide the 2 end legs in place

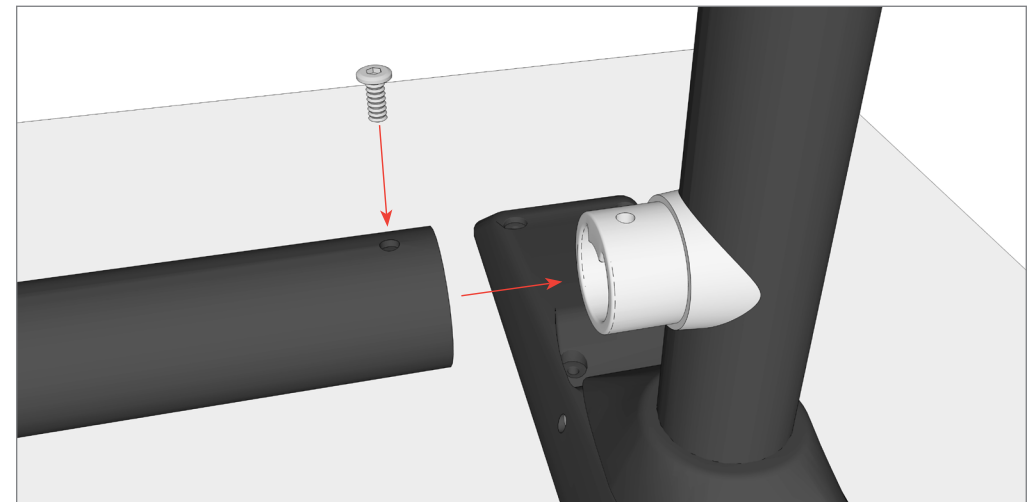

STEP 2: Fully tighten 2 small screws into the cross tube.

MODULUS FILP TABLE

Installation Guide

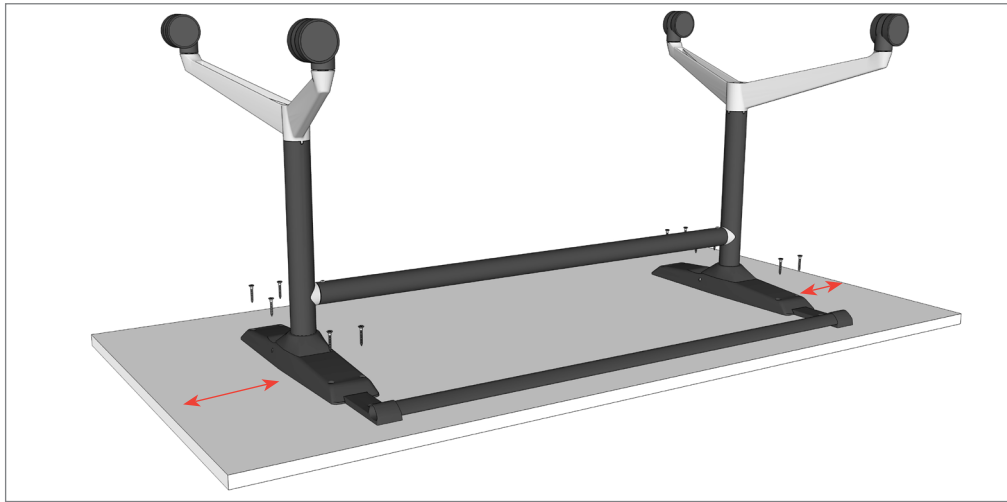

STEP 3: Ensure the frame is located in the centre of the worksurface.

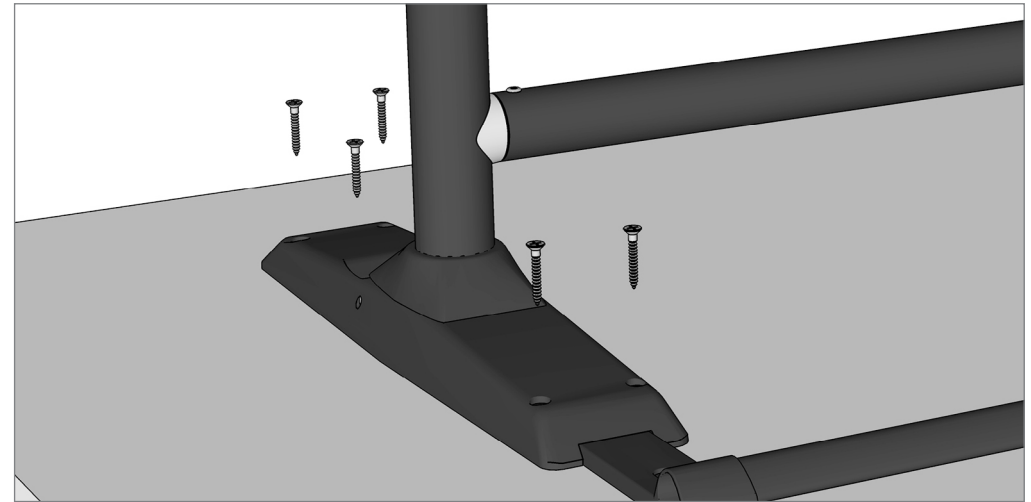

STEP 4: Fully tighten all 6 screws on each mechanism.

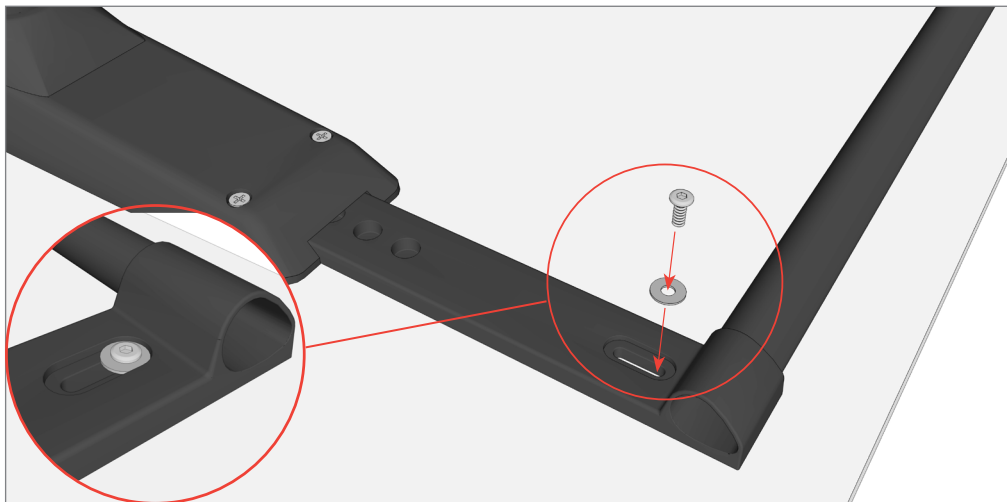

STEP 5: On all tables with width larger than 700mm, secure the pull bar with the supplied washer and screw in the location pictured above (slot end closest to the pull-bar). Leave screw 1 turn from tight so the pull-bar can be operated smoothly.



COMPLETE: Using 2 people rotate table into upright position.

MODULUS FILP TABLE - CONNECTORS/LINKS

Installation Guide

Drilling Patterns for Optional Connectors/Links

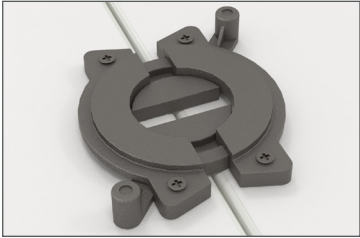

Locked

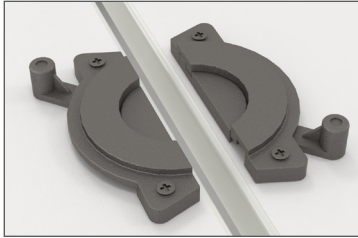

Unlocked

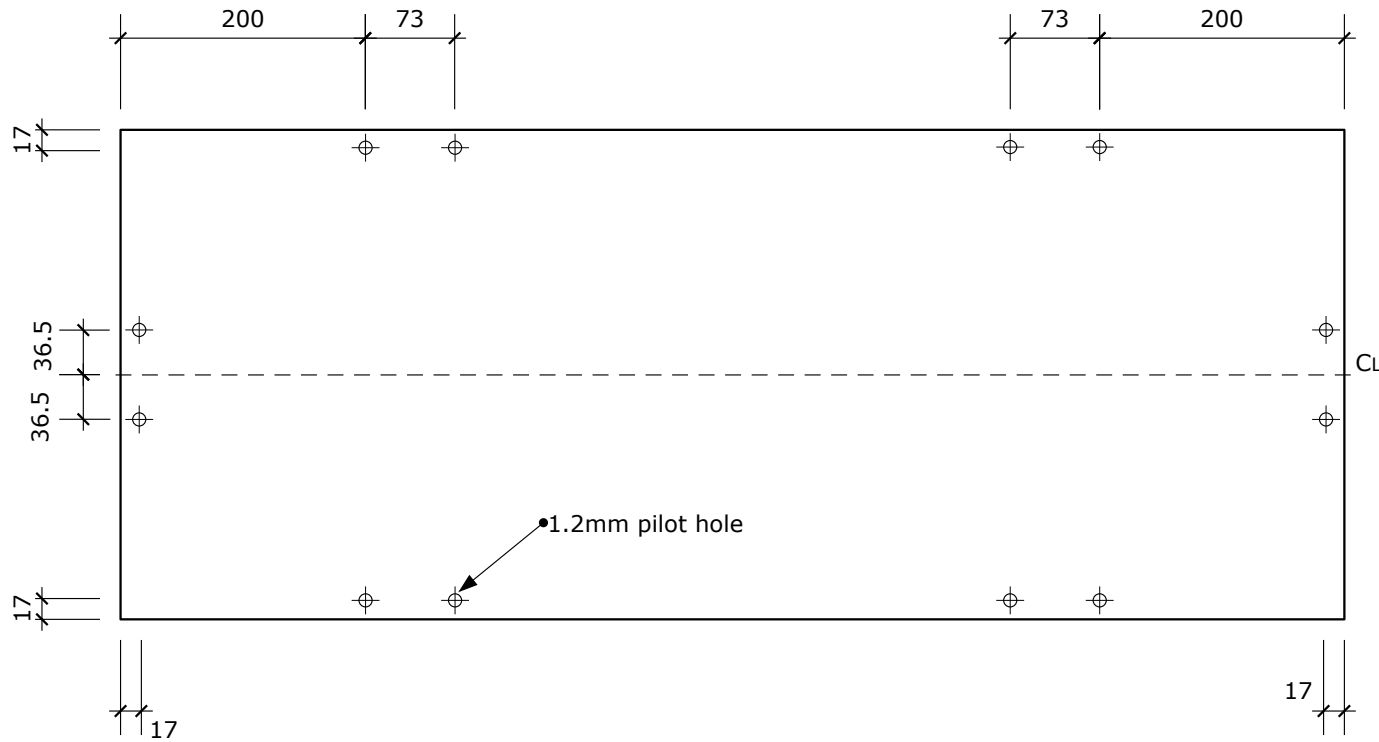

MODULUS FLIP TABLE

Installation Guide

Drilling Patterns for Modulus/Uni Flip Tables Mechanism & Pull Bar

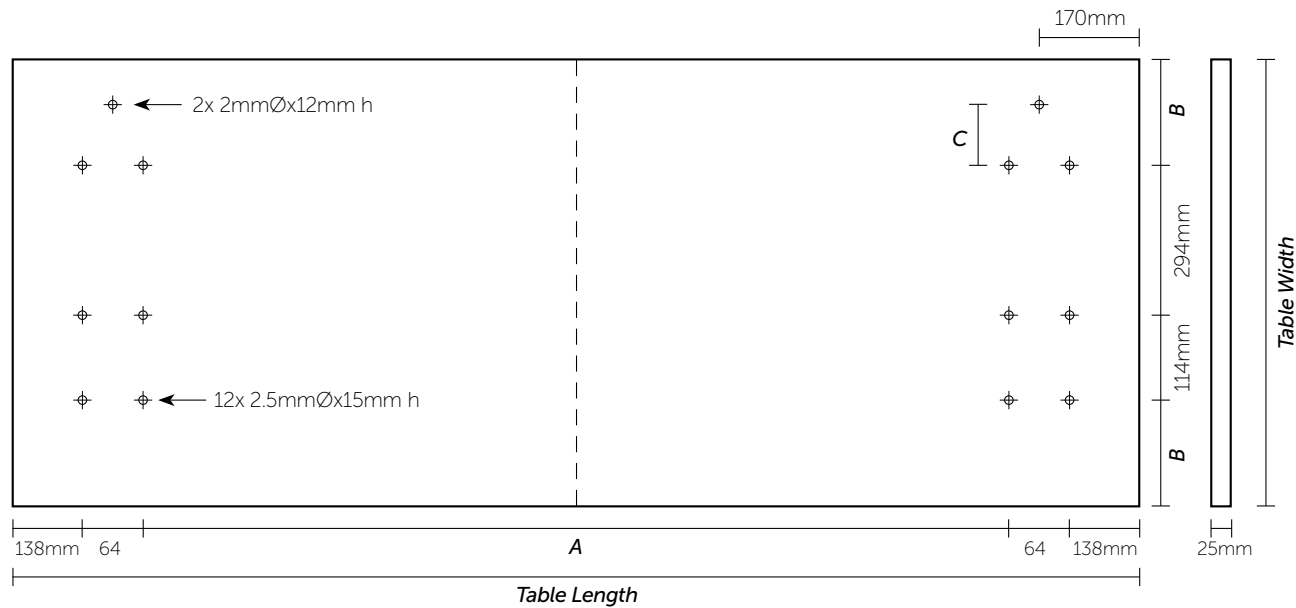

Width-600mm	A	B	C
1200mm	796	96	NA
1500mm	1096	96	NA
1800mm	1396	96	NA

Width-750mm	A	B	C
1200mm	796	171	100
1500mm	1096	171	100
1800mm	1396	171	100

Width-900mm	A	B	C
1200mm	796	246	175
1500mm	1096	246	175
1800mm	1396	246	175



Modulus 4 Post Pedestal Table

Installation Guide

TOOLS REQUIRED: Powered screwdriver.

Modulus 4 Post Pedestal Table

INSTALLATION GUIDE

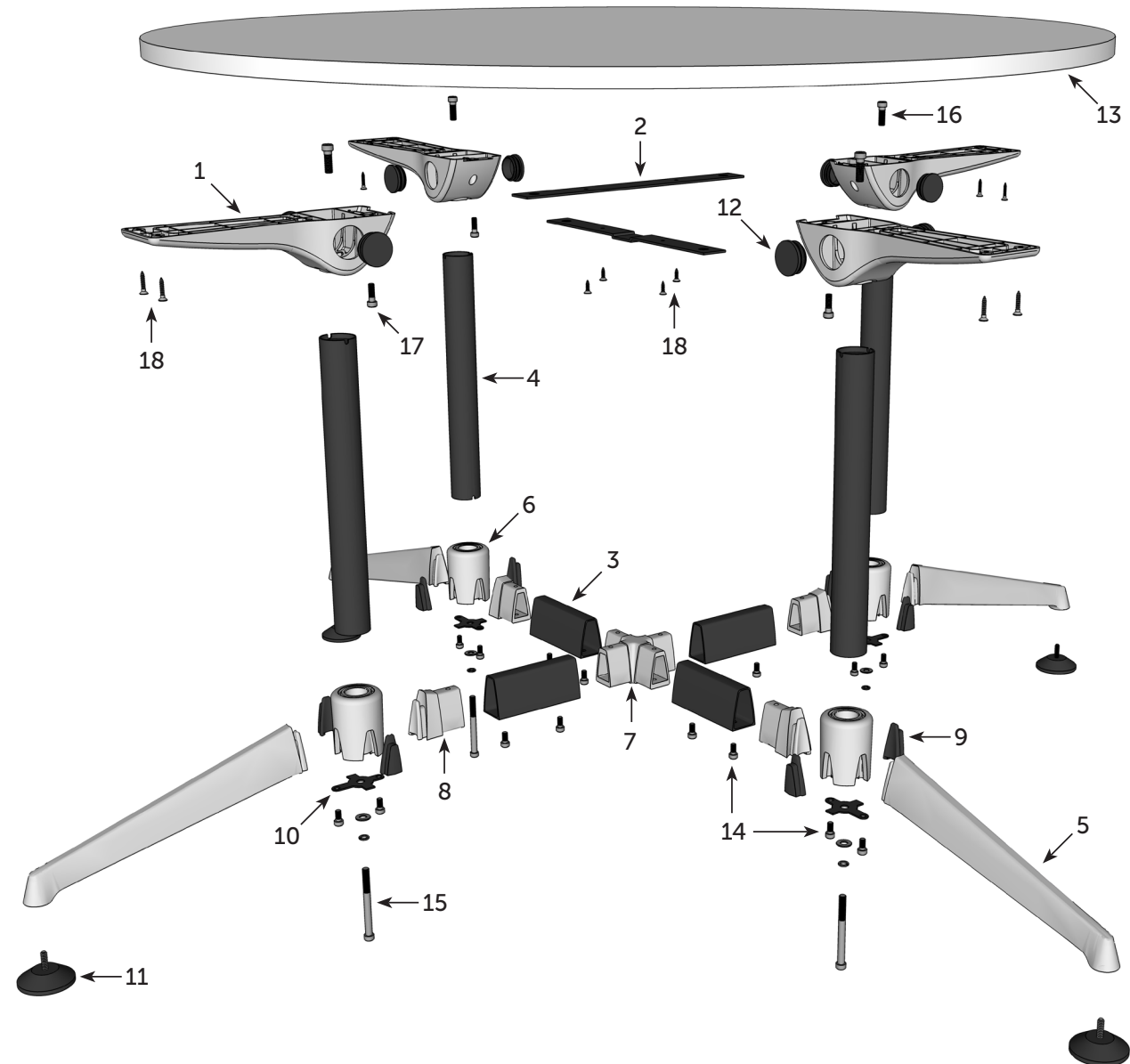

COMPONENTS

- 1 Die Cast Upper Wrist x4
- 2 Steel Strap x2
- 3 T Tube x4
- 4 Feet Tube x4
- 5 Large Foot x4
- 6 Cross Collar x4
- 7 Cross Connector x1
- 8 T Tube & Collar Connector x4
- 9 Cross Collar Plug x8
- 10 Minus Gasket x4
- 11 Foot Glide x4
- 12 Top Rail Cap x8
- 13 Table Top x1

SCREWS

- 14 M8x16mm x16
- 15 M10x110mm x4
- 16 M10x30mm x4
- 17 M6x25mm x4
- 18 M5x20mm Self Tapping x12

Modulus 4 Post Pedestal Table

INSTALLATION GUIDE

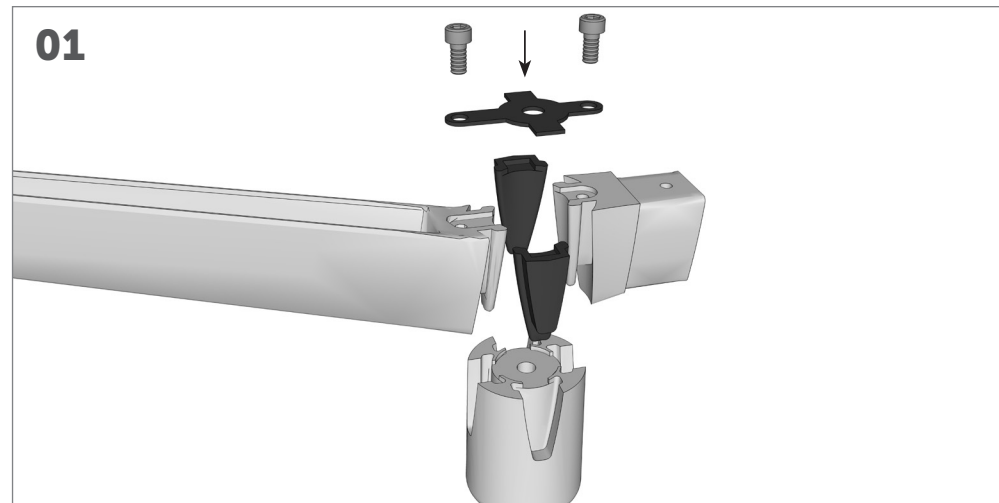

01
Slide the large foot, T connector and 2 cross collar plugs into the cross collar, place the minus gasket on top, and fully tighten the 2 bolts into the collar. *(Repeat with all 4 legs)*



02
Screw the 4 glides into the base of the large feet, leaving the glides one turn from tight (then they can be adjusted easily if the floor is uneven).

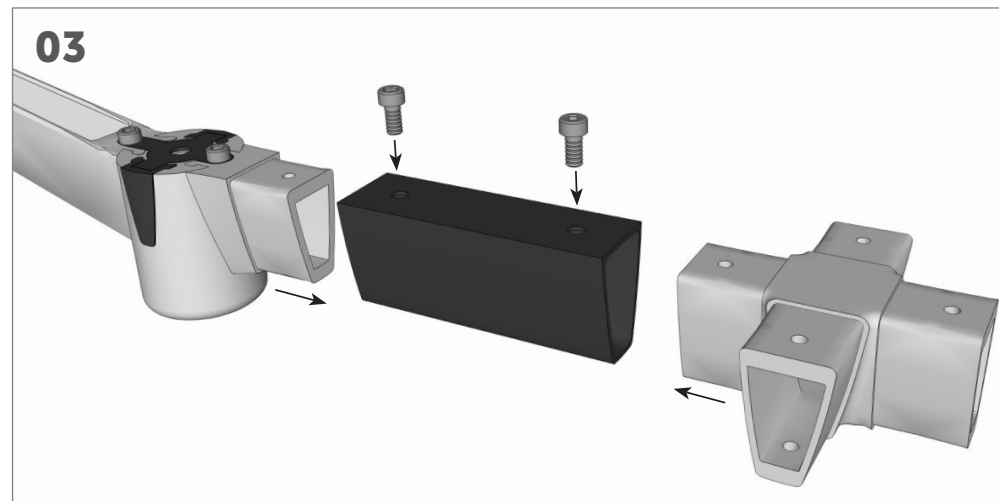

03
With all 4 feet assembled, connect them to the T tube and cross connector using M8x16mm bolts.

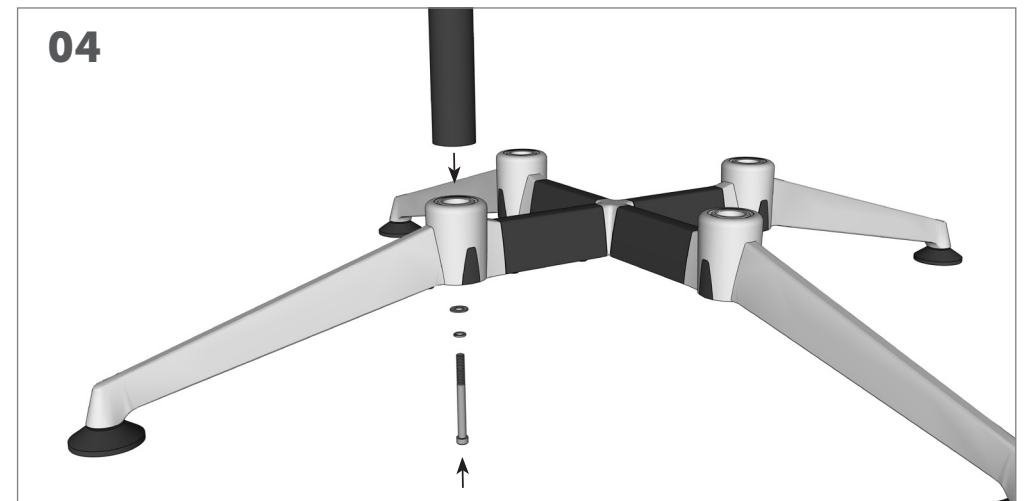

04
Place the 4 feet tubes onto the cross collars. Fully tighten to maximum tension M10x110mm bolts, spring washer and flat washer, that hold the feet tube onto the cross collar. *(Repeat with all 4 tubes)*

Modulus 4 Post Pedestal Table

INSTALLATION GUIDE

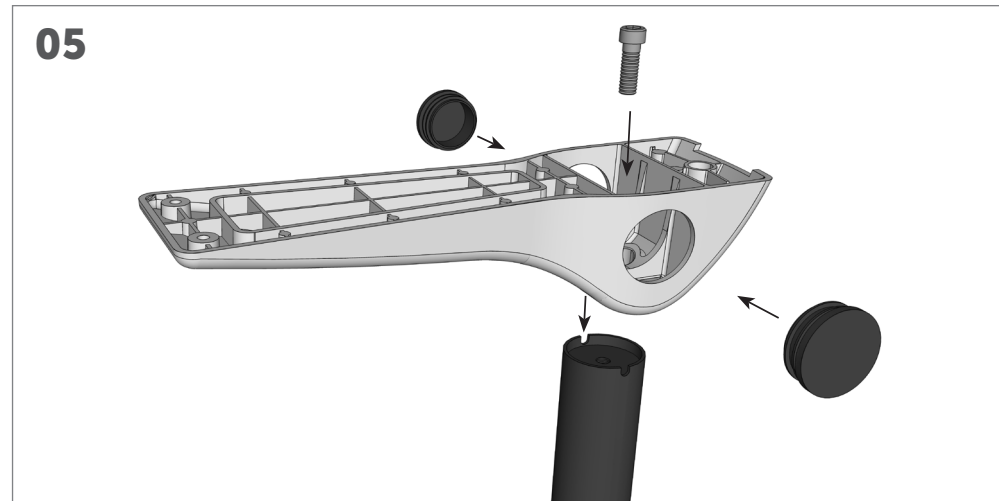

Place each upper wrist on top of the feet tubes. Place the top rail caps into the large holes. Fully tighten to maximum tension M10x30mm bolts to hold the upper wrist in place.

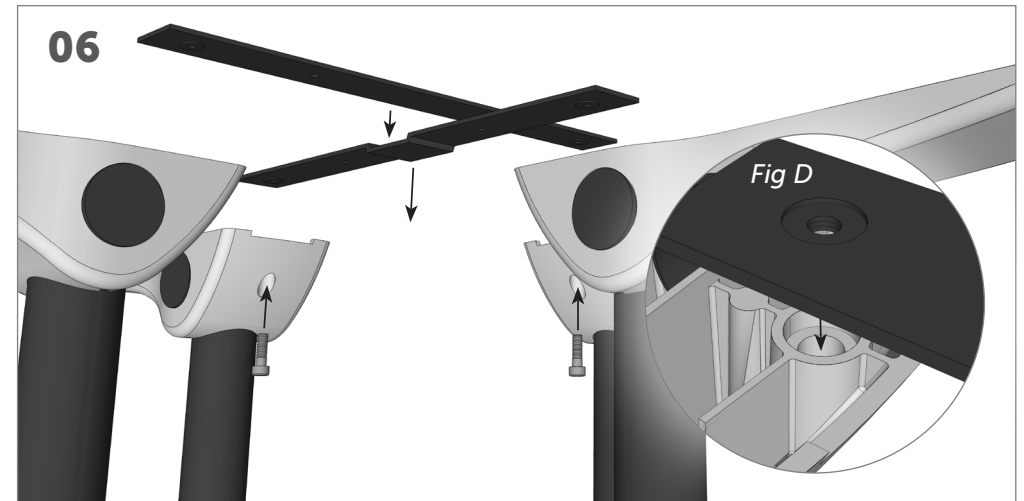

Place the 2 steel straps onto the upper wrists, with the raised areas of the straps slotting into the holes on the upper wrist, **Fig D**. Fully tighten to maximum tension the M6x25mm bolts, locking the upper frame into place.

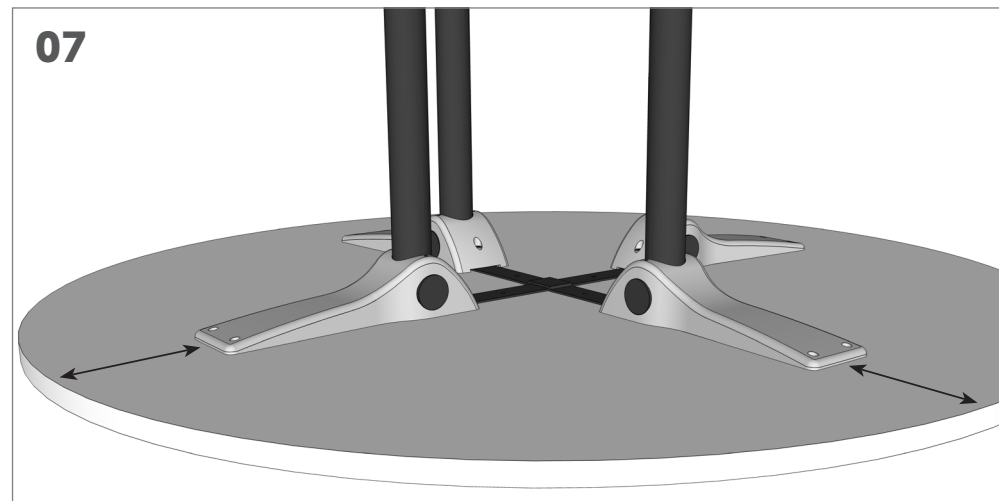

Carefully place the assembled frame upside down on top of the work surface. Measure the distance from the upper wrist to the edge of the work surface, and make sure the frame is centered over the work surface.

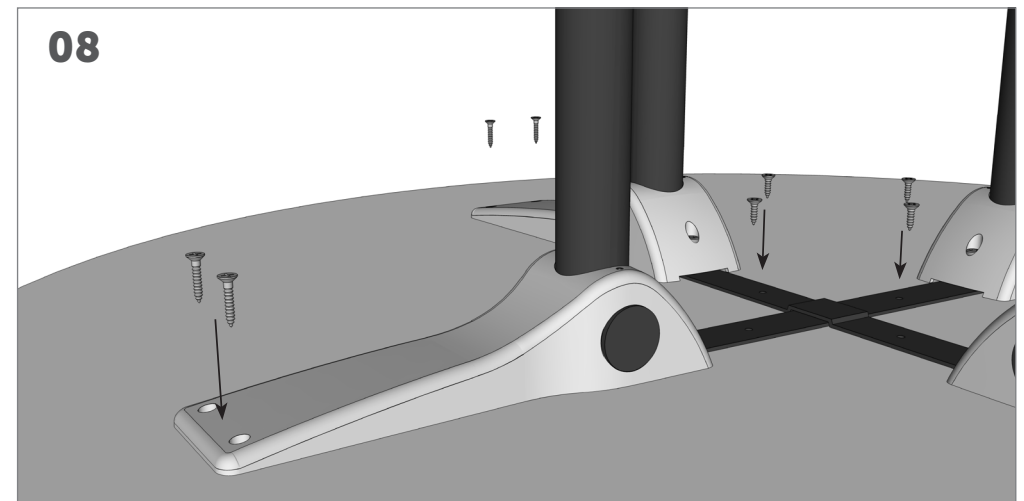

Screw the M5x20mm self tapping screws into the work surface, located on the upper wrist and steel straps.

Modulus 4 Post Pedestal Table

INSTALLATION GUIDE



Modulus Single Post Pedestal Table

Installation Guide

TOOLS REQUIRED: Powered screwdriver.

Modulus Single Post Pedestal Table

INSTALLATION GUIDE

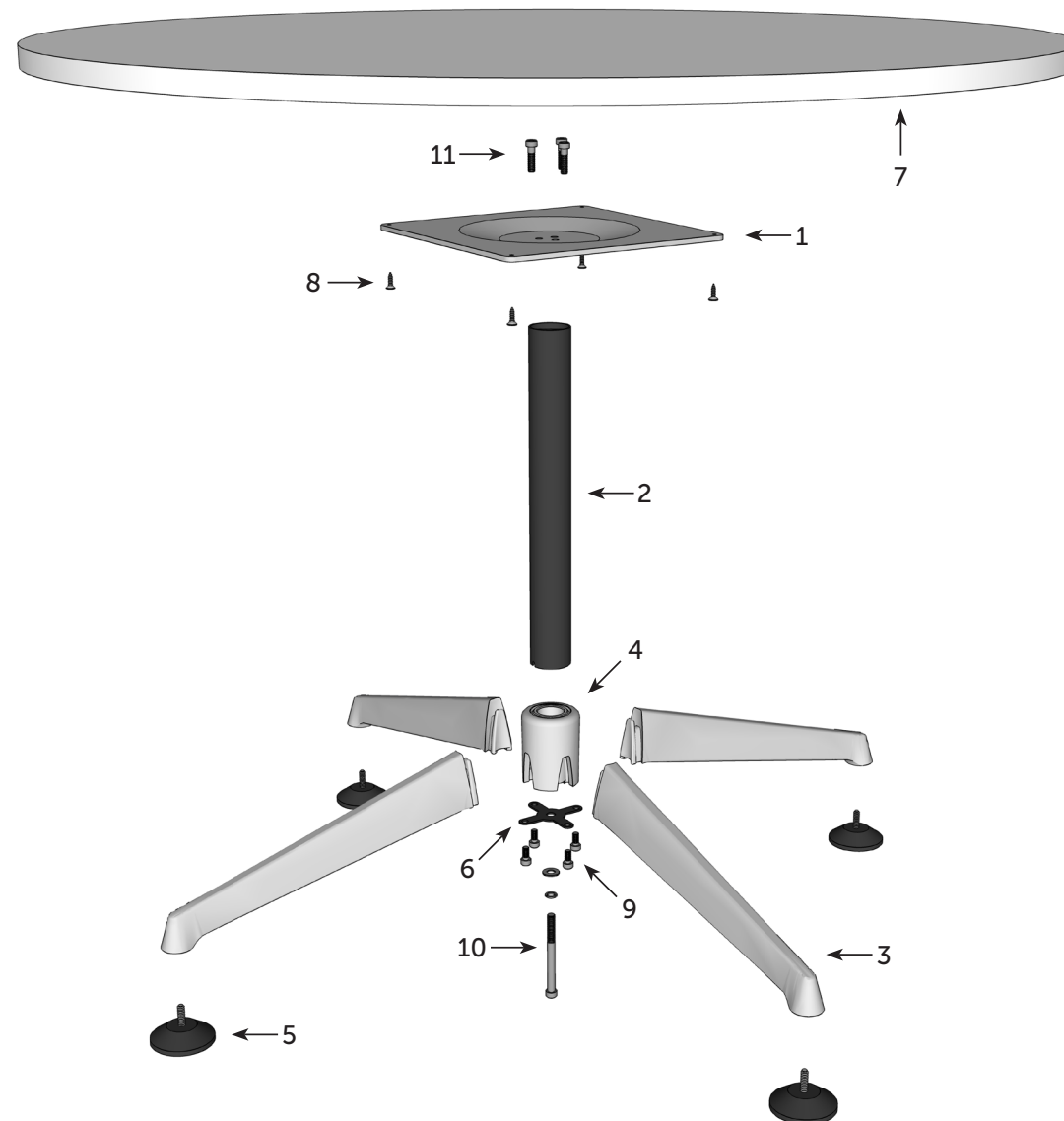

COMPONENTS

- 1 Steel Plate x1
- 2 Feet Tube x1
- 3 Large Foot x4
- 4 Cross Collar x1
- 5 Foot Glides x4
- 6 Cross Gasket x1
- 7 Table Top x1

SCREWS

- 8 M5x20mm Self Tapping x4
- 9 M8x16mm x4
- 10 M10x110mm x1
- 11 M8x30mm x3

Modulus Single Post Pedestal Table



INSTALLATION GUIDE

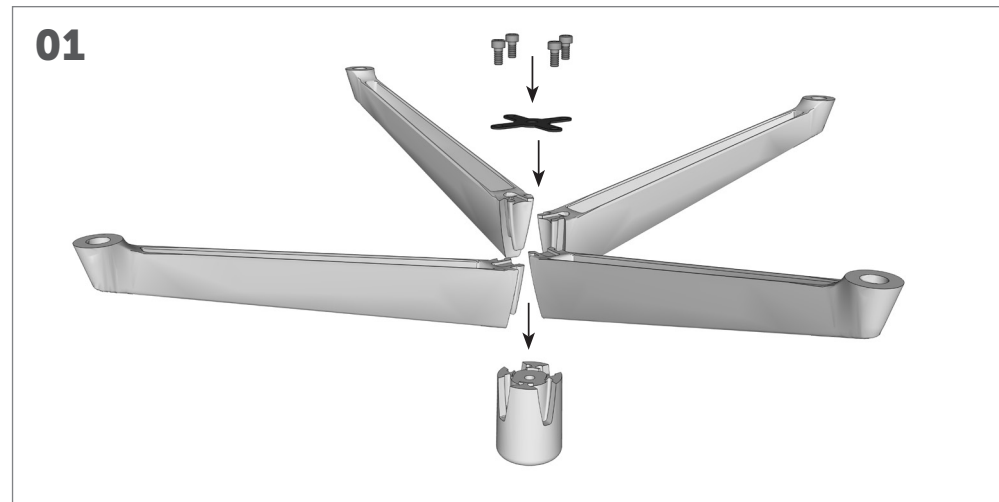

01 Slide the 4 large feet into the cross collar. Place the cross gasket on top of the feet and collar, and tighten 4xM5 screws into the cross collar.

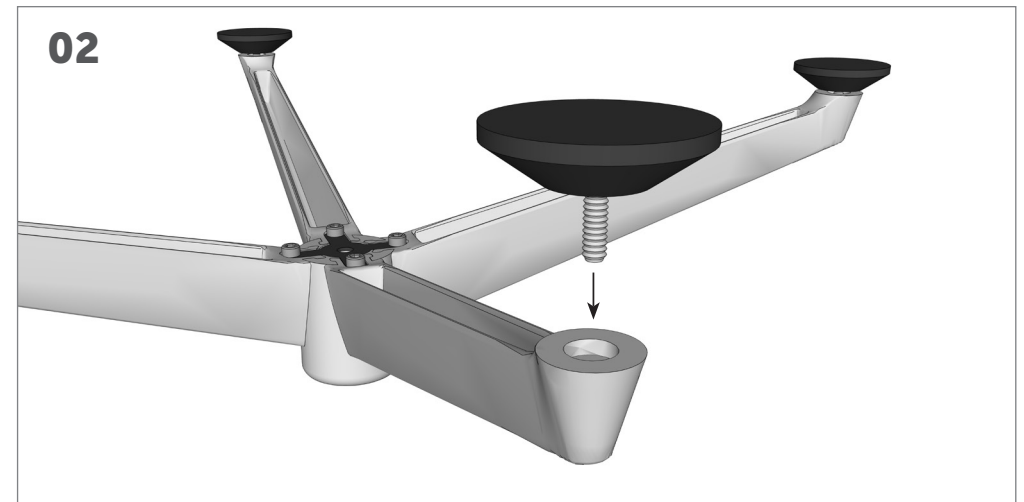

02 Screw the 4 glides into the base of the large feet, leaving the glides one turn from tight (then they can be adjusted easily if the floor is uneven).

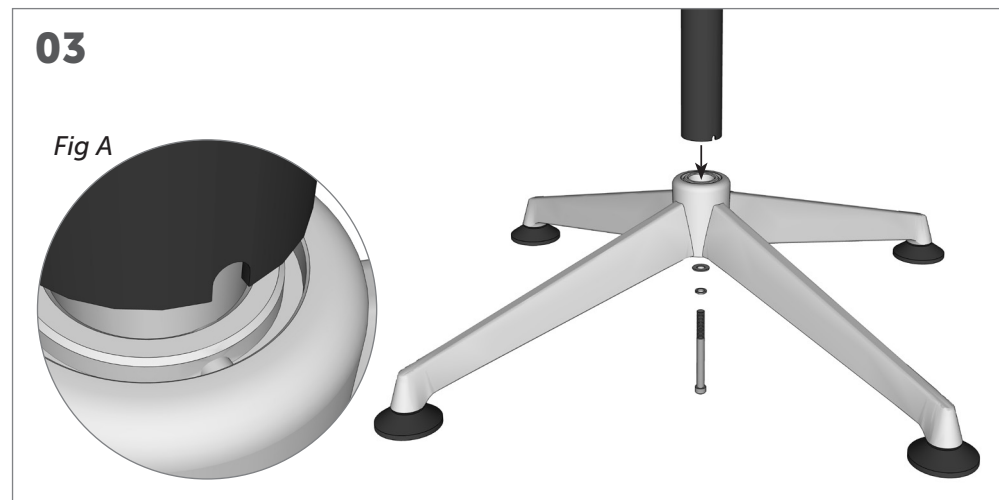

03 Place the feet tube into the cross collar, making sure the notch in the bottom of the tube is in-line with the bump inside the cross collar **Fig A**. Fully tighten the large M10 bolt, spring washer and flat washer through the gasket and collar into the tube.

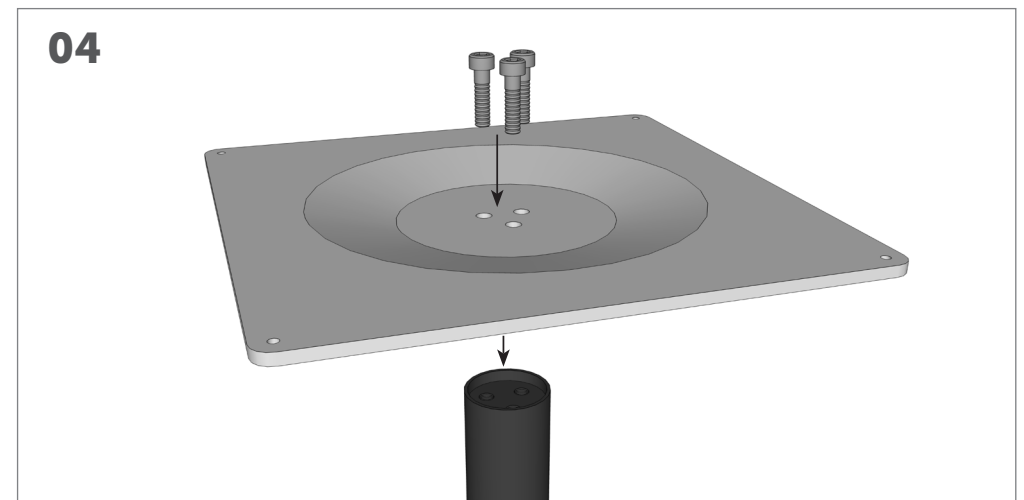

04 Locate the steel plate on top of the feet tube, and line up the 3 holes. Fully tighten the 3 screws into the tube.

Modulus Single Post Pedestal Table

INSTALLATION GUIDE

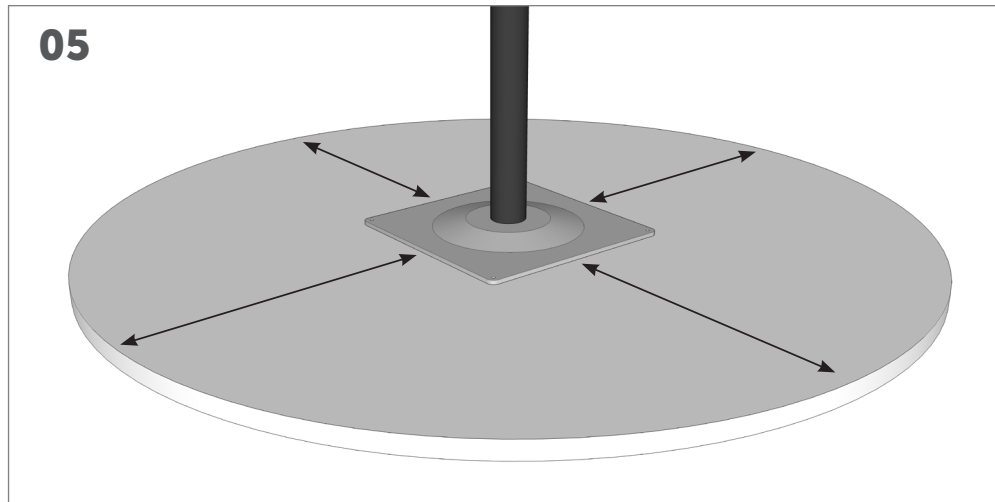

With the frame assembled, place it upside down onto the work surface, and measure the top from all sides to make sure it's centered.

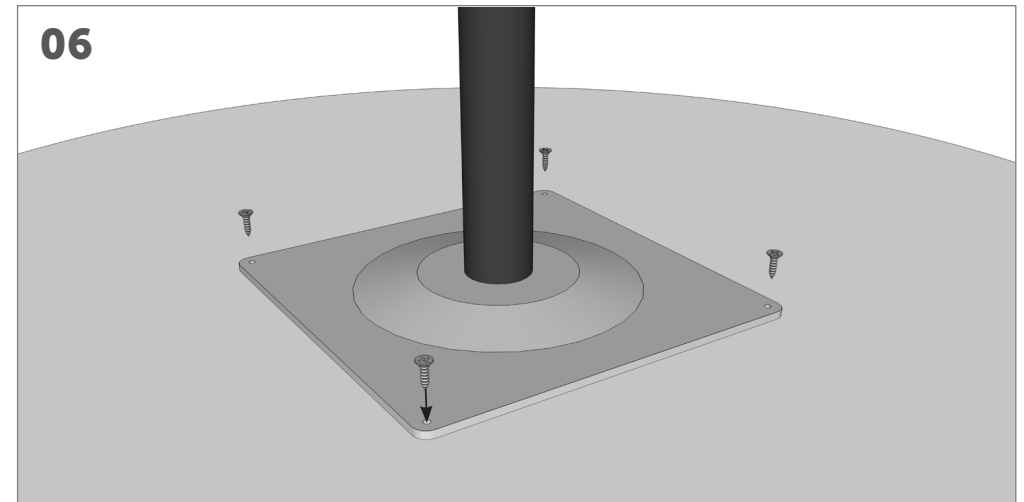

Fully tighten the last 4 self tapping screws into the work surface.



Modulus Single Post Collar Leg Table - Single Span

Installation Guide - Version 2

TOOLS REQUIRED: Powered screwdriver.

Modulus Single Post Collar Leg Table - Single Span



INSTALLATION GUIDE

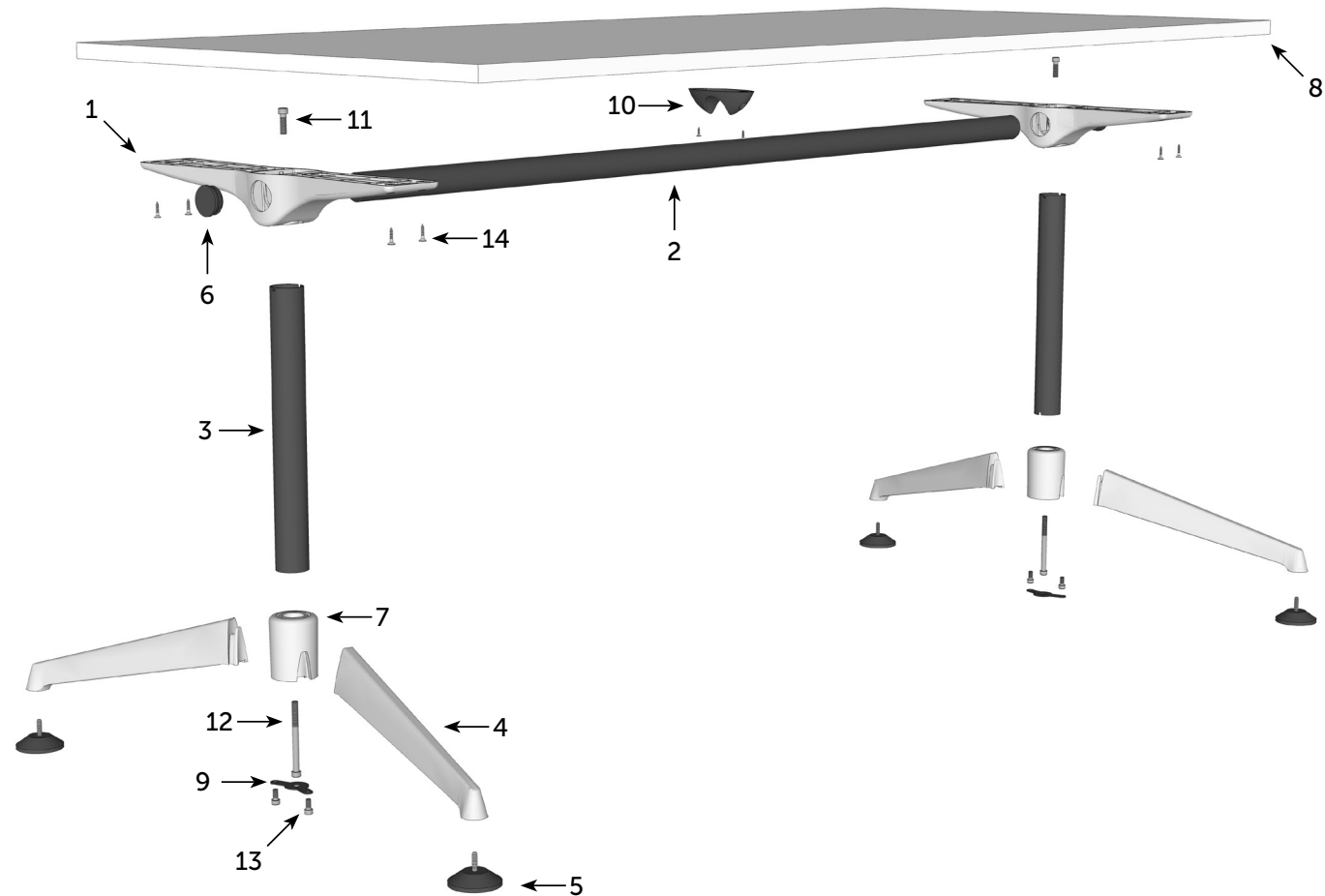

COMPONENTS

- 1 Upper Wrist x2
- 2 Top Rail Ø45 x1
- 3 Leg-pole Tube Ø51 x2
- 4 Large Foot x4
- 5 Foot Glide x4
- 6 Top Rail Cap x2
- 7 150° Collar x2
- 8 Table Top x1
- 9 150° Gasket x2
- 10 Plastic Support x1

SCREWS

- 11 M10x30mm x2
- 12 M10x110mm x2
- 13 M8x16mm x4
- 14 M5x25mm Self Tapping

Modulus Single Post Collar Leg Table - Single Span

INSTALLATION GUIDE

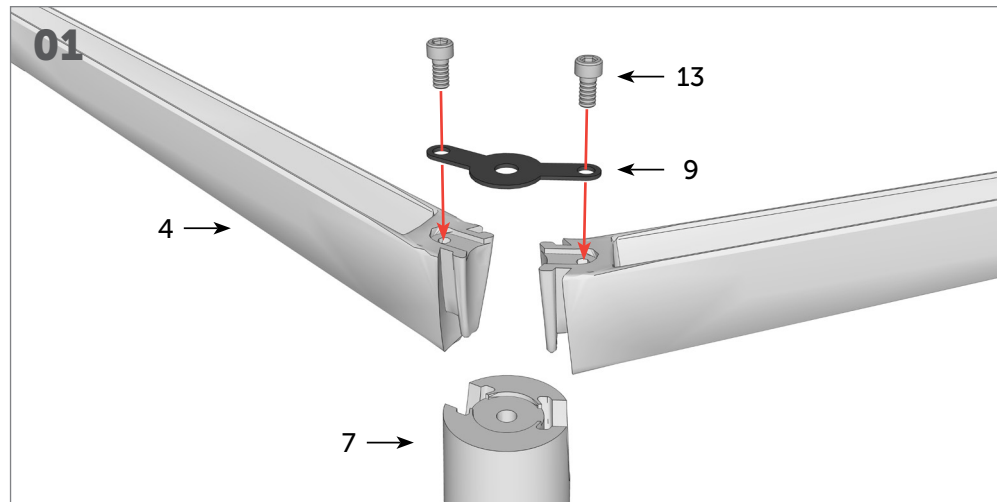

Slide 2 large feet⁴ into the collar, place the 150° gasket⁹ on top and fully tighten the 2 M8x16mm bolts¹³ into the collar⁷. (Repeat with all collars).



Screw all glides⁵ into the base of the large feet, leaving the glides one turn from tight (then they can be adjusted easily if the floor is uneven).

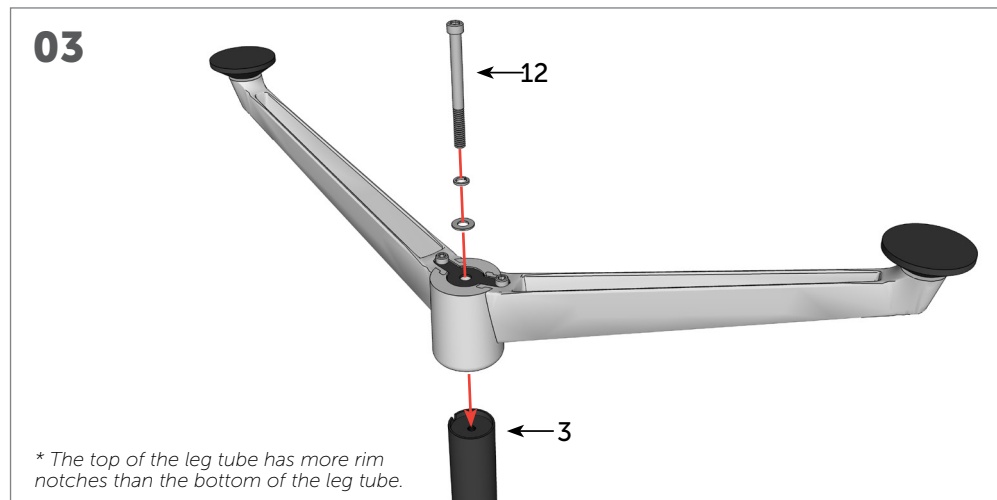

** The top of the leg tube has more rim notches than the bottom of the leg tube.*

Place a leg pole tube³ on top of a collar. Align the notch. Fully tighten the M10x110 bolt¹², spring washer and flat washer through the collars. Repeat for both leg assemblies.

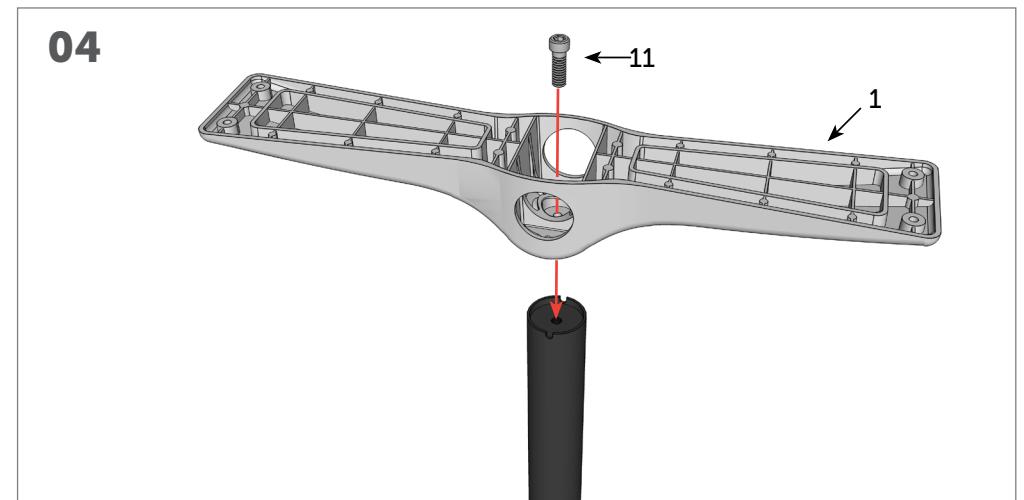

Place the upper wrist¹ on top of the leg tube, making sure each small notch in the top of the leg tube is in-line with the bumps on the bottom of the upper wrist. Fully tighten to maximum tension the M10x30mm bolts¹¹. Repeat for both leg assemblies.

Modulus Single Post Collar Leg Table - Single Span



INSTALLATION GUIDE

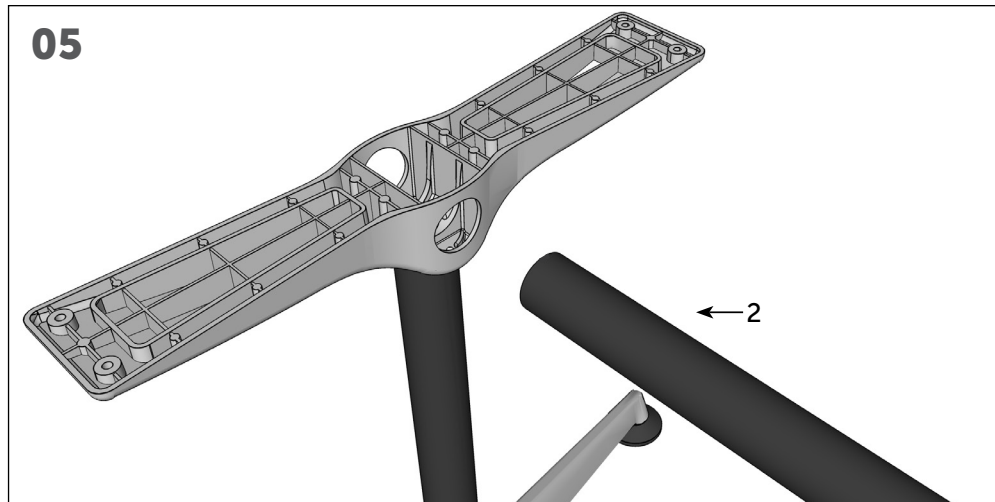

With the legs assembled, place each end of the top rail² into the holes on the side of the upper wrist, making sure they stop before going all the way through. (It is permissible in some applications for top rail to protrude out further past the wrists.)

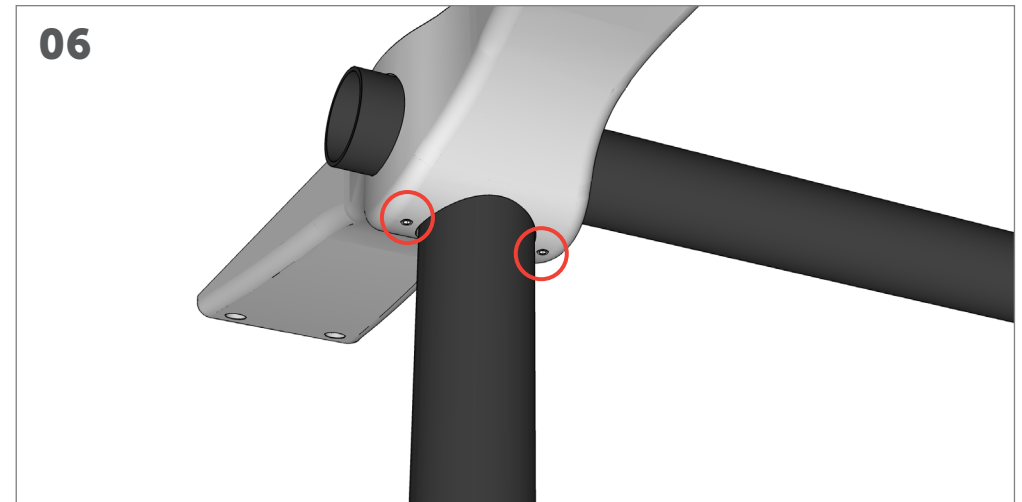

Fully tighten the small screws located at the bottom of each upper wrist to firmly hold the top rail in place.

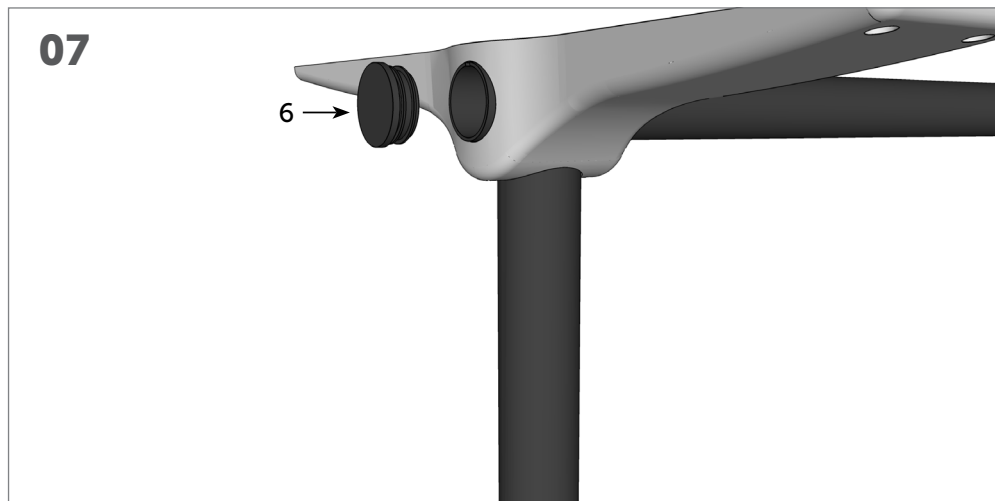

Place the top rail cap⁶ into the exposed side end of the top rail.



Locate the plastic support bracket¹⁰ over the centre of the top rail, and click into place.

Modulus Single Post Collar Leg Table - Single Span

INSTALLATION GUIDE

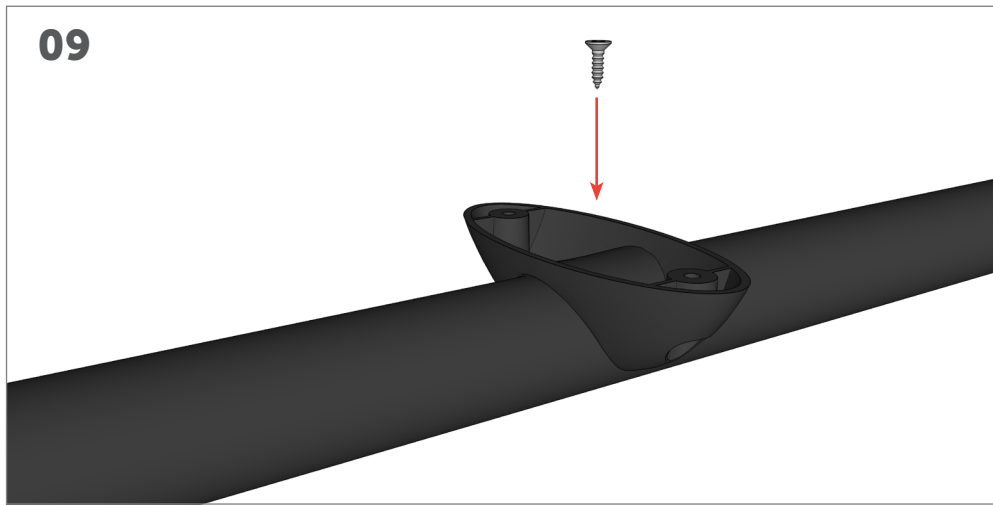

Optional: For extra strength, the plastic support bracket can be screwed onto the top rails.

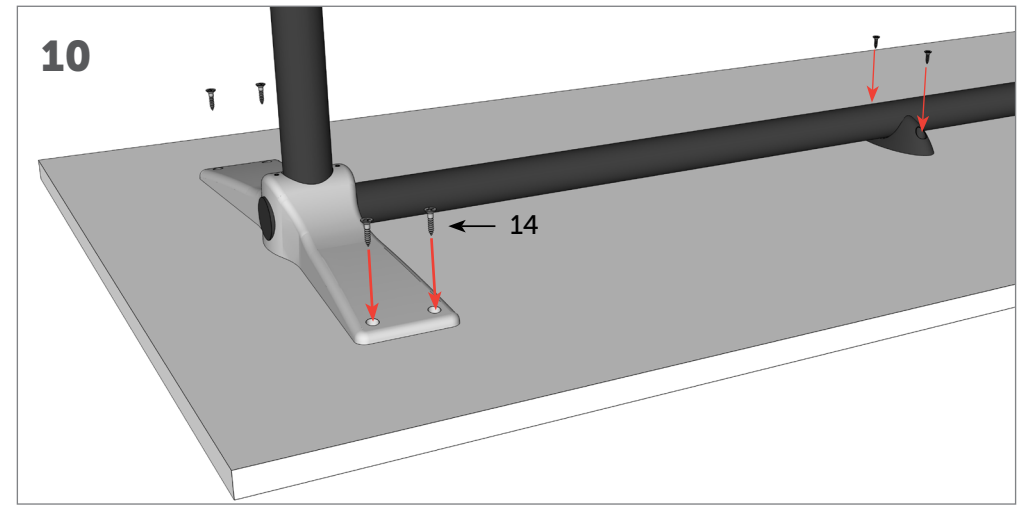

With the frame assembly complete, locate it in the centre of the work surface and screw the remaining self tapping screws¹⁴ into each upper wrist and plastic support.

