

---

## Rover Range (50-ROMPL-0916)

Assembly Instructions

# Rover Range (50-ROMPL-0916)

## Components List



38 x 6x35mm  
Cam Bolt

C1



8 x 8x30mm  
Dowel Pin

D1



38 x 5/8"  
Cam Cover

C2



12 x Threaded  
Dowel Pin

P1



20 x 6x25mm  
Fix Bolt

B1

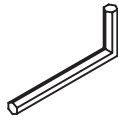

1 x Wrench

A



2 x Castor

T1



2 x Castor

T2

### Pre-installed Parts:

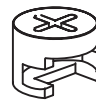

Cam

C5

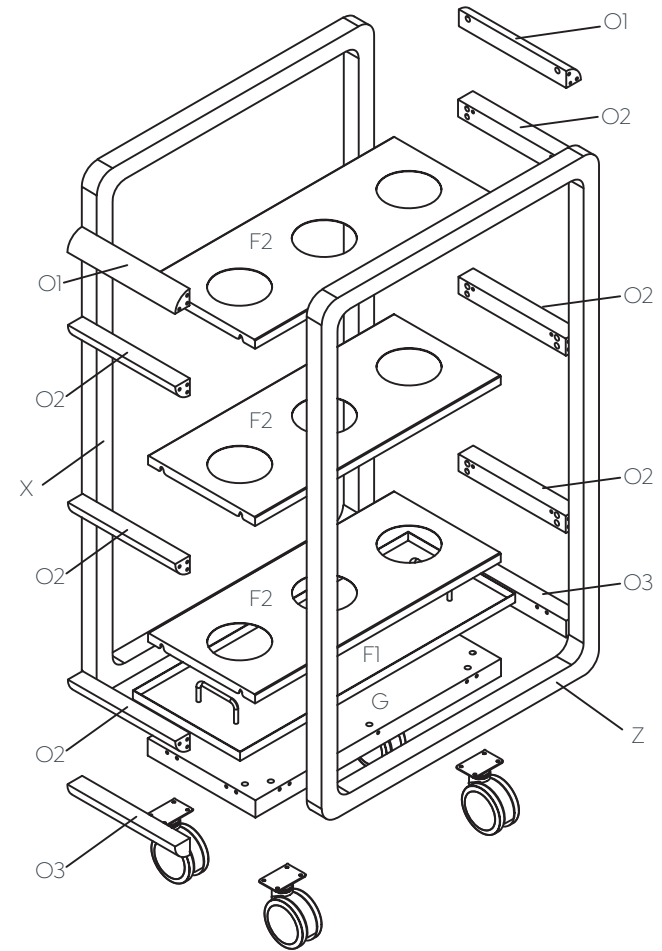

### STEP 1:

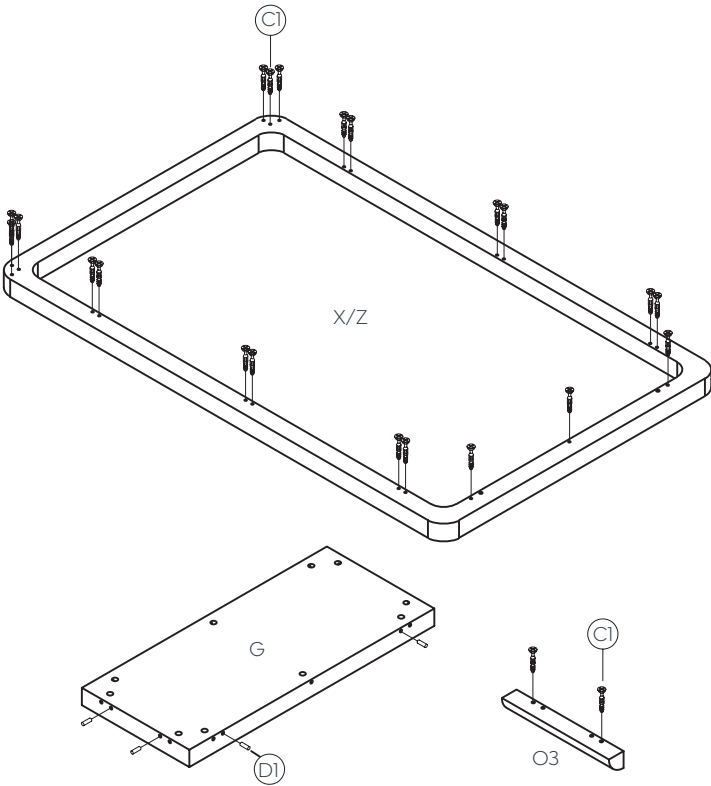

#### Preparation for panel X, Z, O3.

1. Insert cam bolts C1 and dowel pins D1 into panels X, G and Z as illustrated above.

### STEP 2:

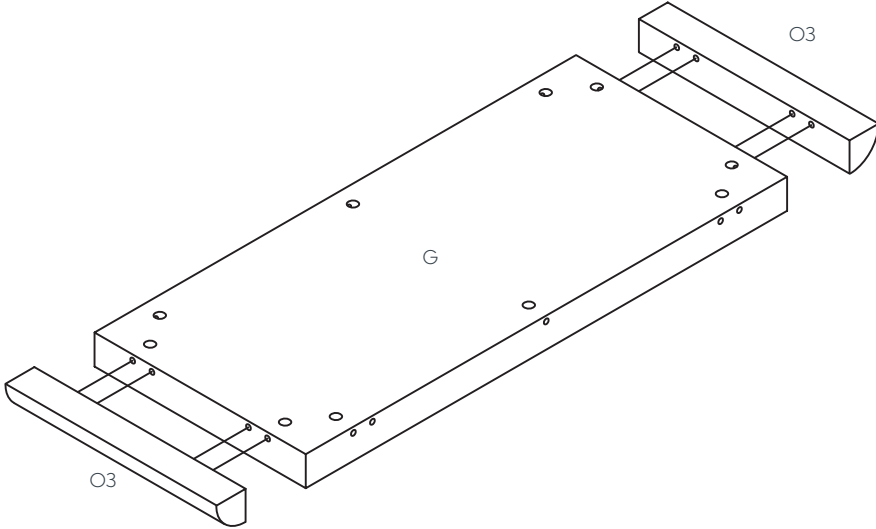

#### Panel O3, G assembly.

1. Insert cam bolts C1 and dowel pins D1 into panel O3 into cams on panel G and tighten in a clockwise direction as illustrated above.

# Rover Range (50-ROMPL-0916)

## Assembly Instructions

### STEP 3:

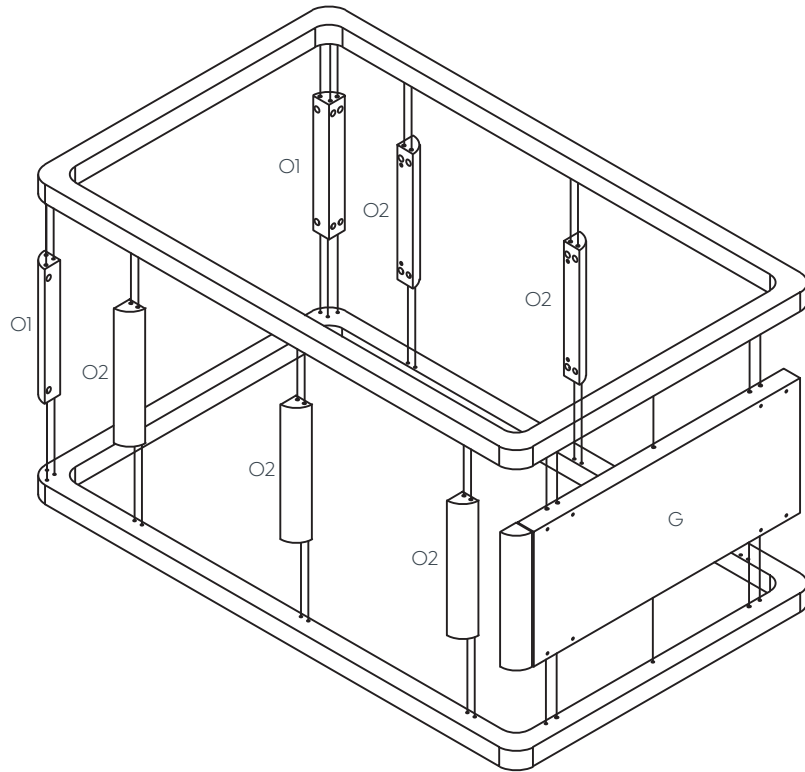

#### Panel Y/Z/O1/O2/O3/G assembly.

1. Insert cam bolts C1 and dowel pins D1 into panels X/Z into cams on panel O1/O2/O3/G and tighten in a clockwise direction as illustrated above.

### STEP 4:

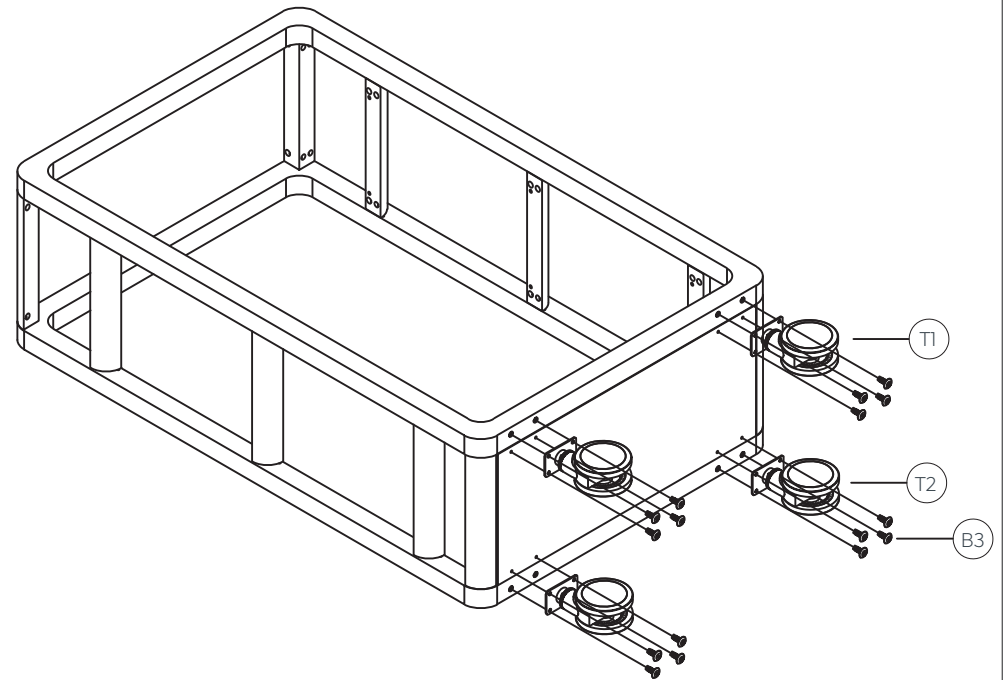

1. Install castors T1 and T2 using screws B3.

## STEP 5:

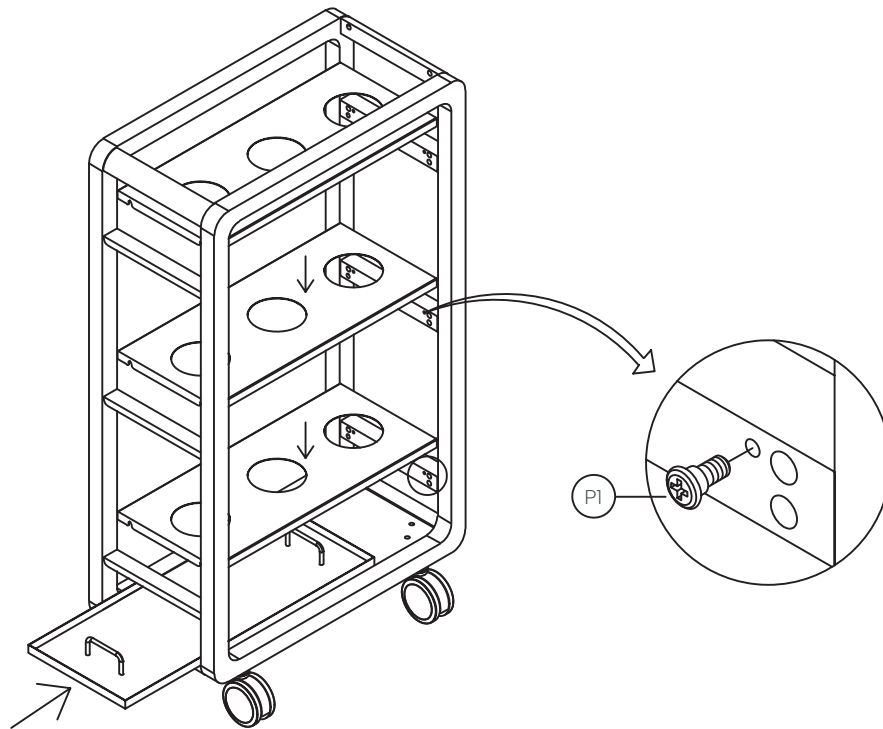

### Moveable shelf E assembly.

1. Insert threaded dowel pins P1 into panels X and Z as illustrated above.
2. Put the three panels F1 on the top of threaded dowel pins P1 as illustrated above.

## Complete:

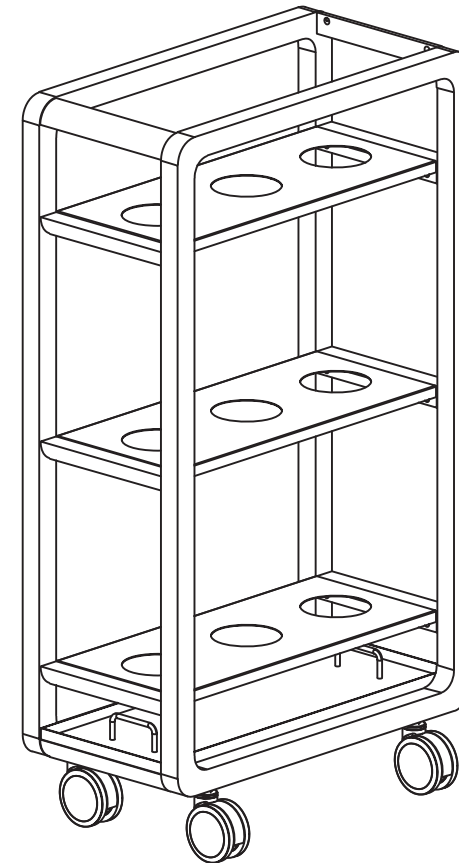

Remove all QC and panel labels and wipe clean using a damp cloth and general household cleaner.



**Sydney** 02 8188 2732

**Melbourne** 03 9111 0315

**Brisbane** 07 3733 1923

**Adelaide** 08 7111 0810

**Perth** 08 9468 2707

[info@olgoffice.com](mailto:info@olgoffice.com)

[myolg.online](https://myolg.online) | [olgoffice.com](https://olgoffice.com) | [officedesigner.net](https://officedesigner.net) | [motionoffice.com](https://motionoffice.com)