

Rhodes Modular Shelving (50-MSCUBB8036)

Assembly Instructions

Rhodes Modular Shelving (50-MSCUBB8036)

Components List

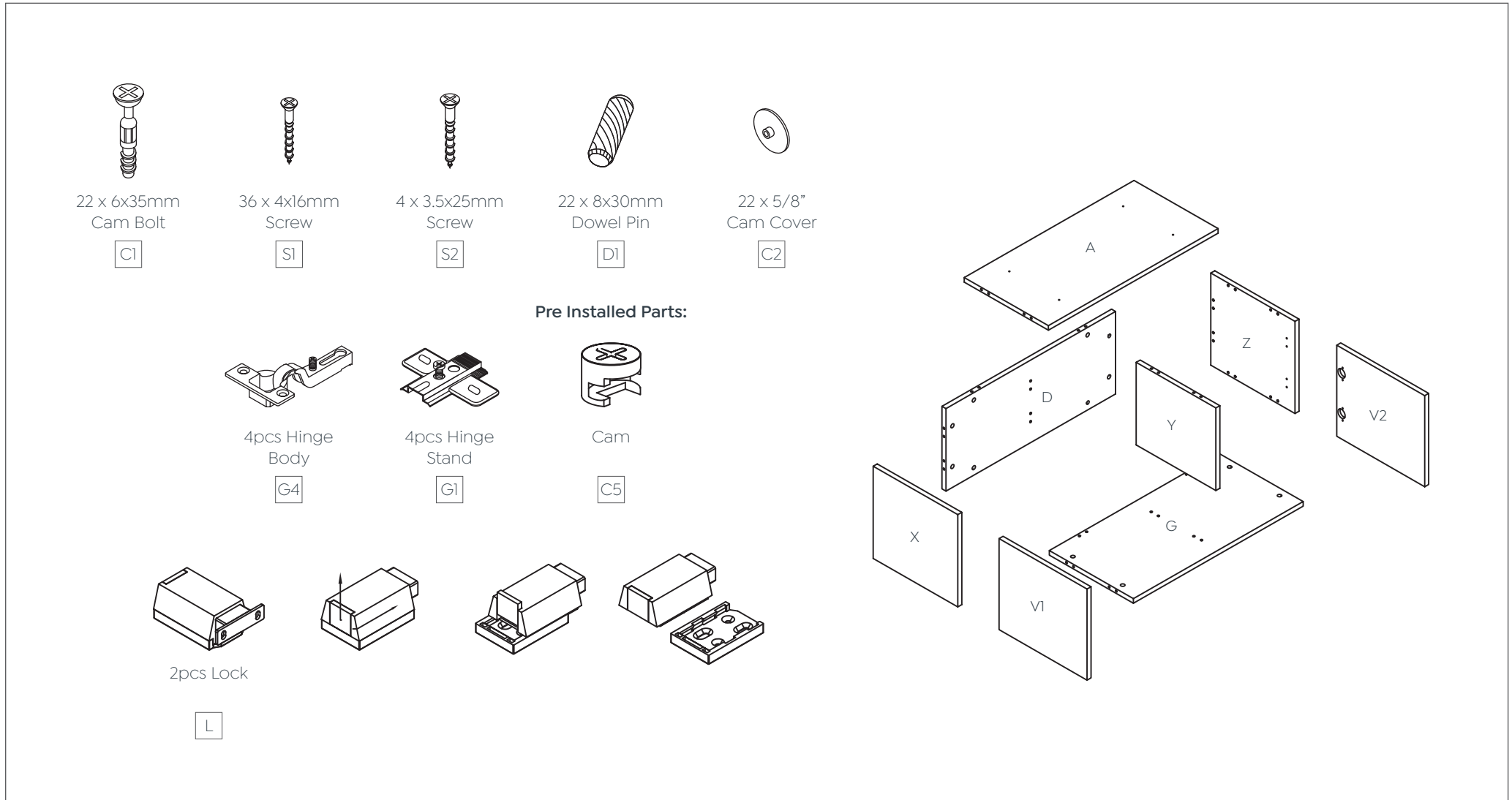

STEP 1:

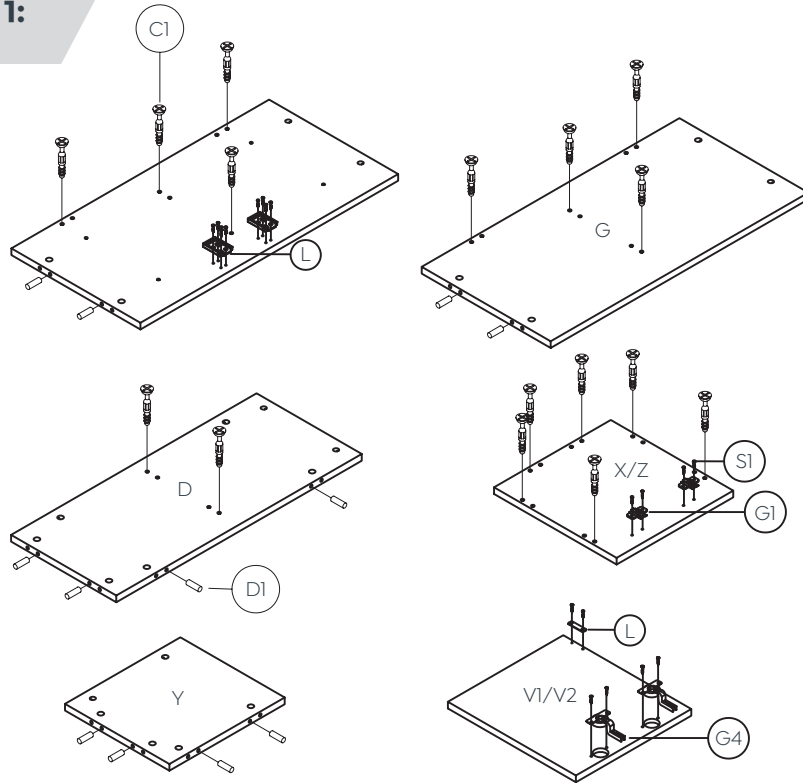

Preparation for panels A, G, X, Z, D, Y, V1 and V2.

1. Insert cam bolts C1 into panels A, G, D, X and Z as illustrated above.
2. Insert dowel pins D1 into panels A, G, D and Y as illustrated above.
3. Fix hinge stands G1 to panels X, Z with screws S1 as illustrated above.
4. Fix hinge body G4 to panels V1, V2 with screws S1 as illustrated above.
5. Locate the trim ring on lock and set aside. Insert cylinder of lock L through hole in A and secure with S1 screws. Add trim ring to lock on outside of V1, V2.

STEP 2:

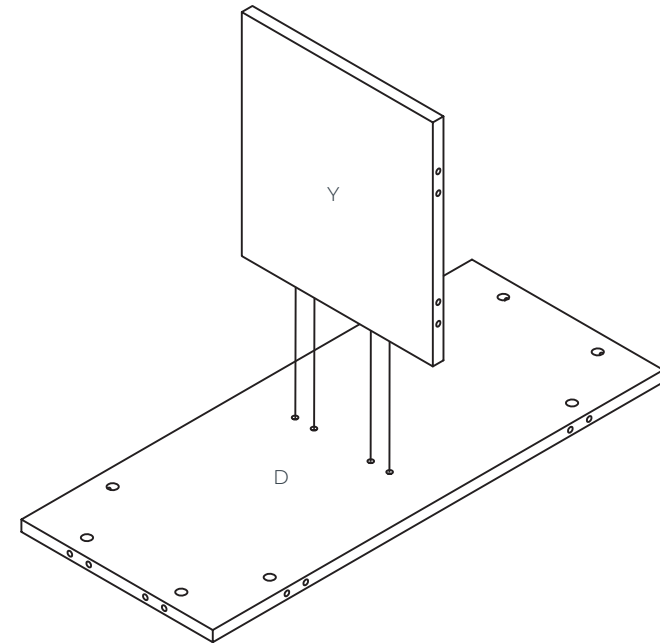

Panel Y and D assembly.

1. Insert cam bolts C1 and dowel pins D1 on panel Y into cams on panel D and tighten in a clockwise direction as illustrated above.

Rhodes Modular Shelving (50-MSCUBB8036)

Assembly Instructions

STEP 3:

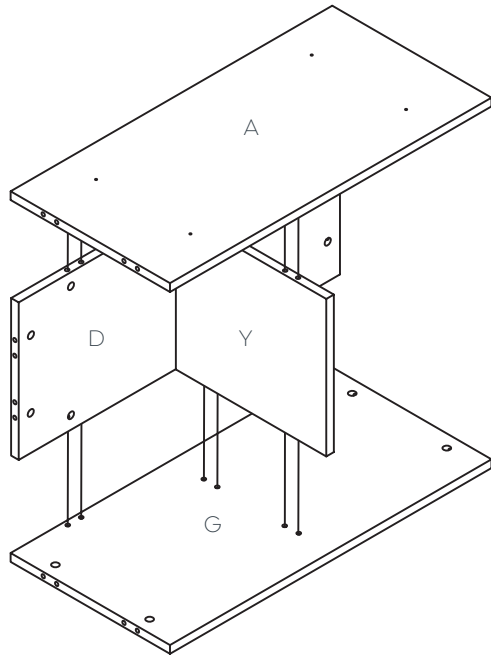

Panel A and G assembly.

1. Insert cam bolts C1 and dowel pins D1 on panel A, G into cams on panel Y, D and tighten in a clockwise direction as illustrated above.

STEP 4:

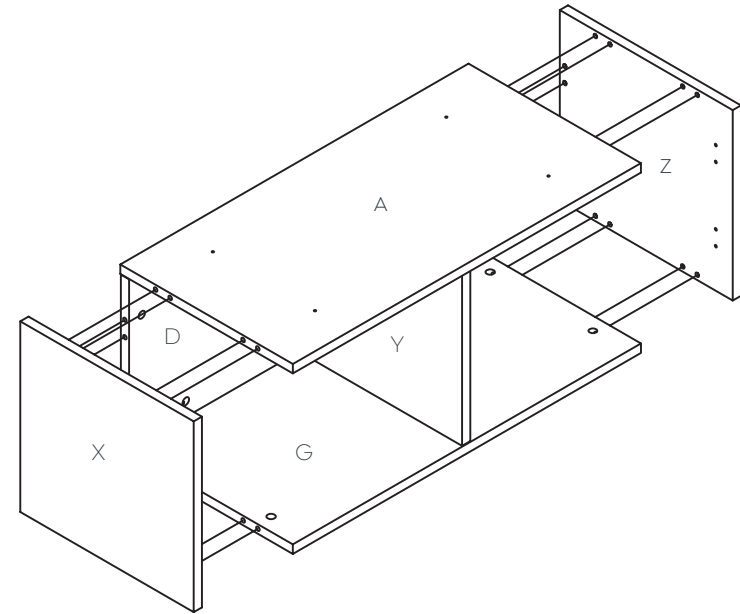

Panels Y and D assembly.

1. Insert cam bolts C1 on panel X and Z into cams on panels A, D, G and tighten in a clockwise direction as illustrated above.

STEP 5:

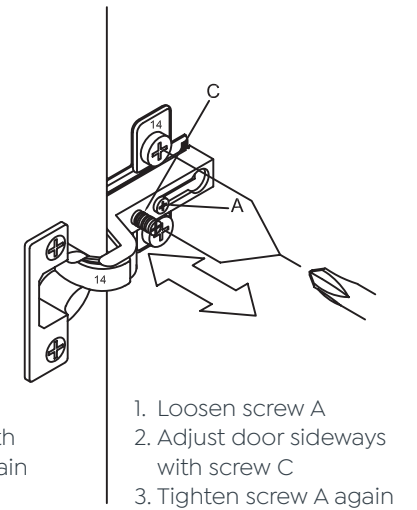
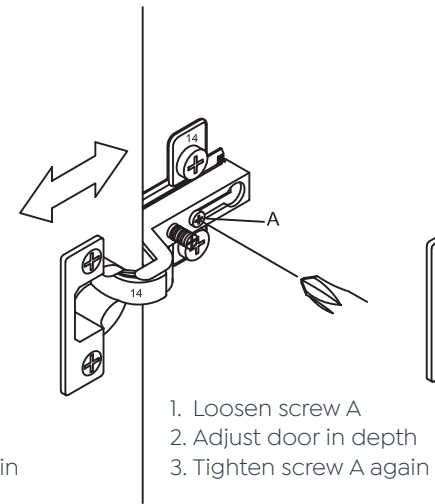
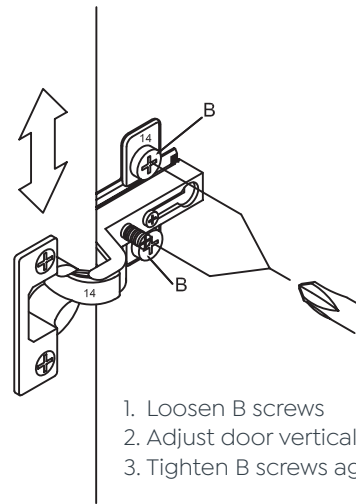
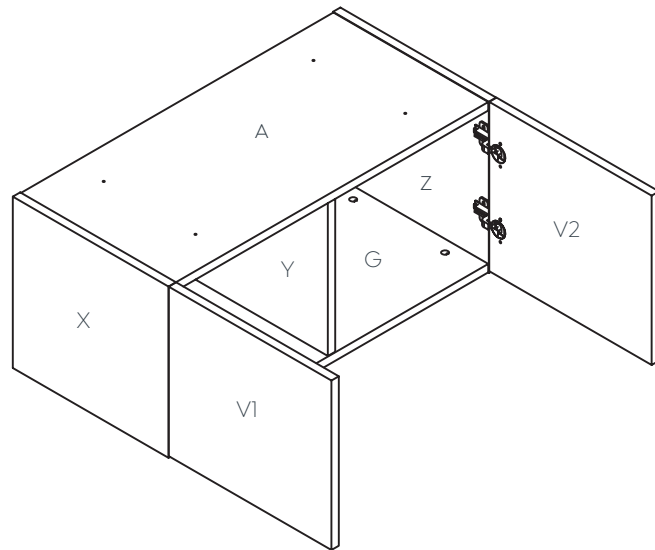

Rhodes Modular Shelving (50-MSCUBB8036)

Assembly Instructions

STEP 6:

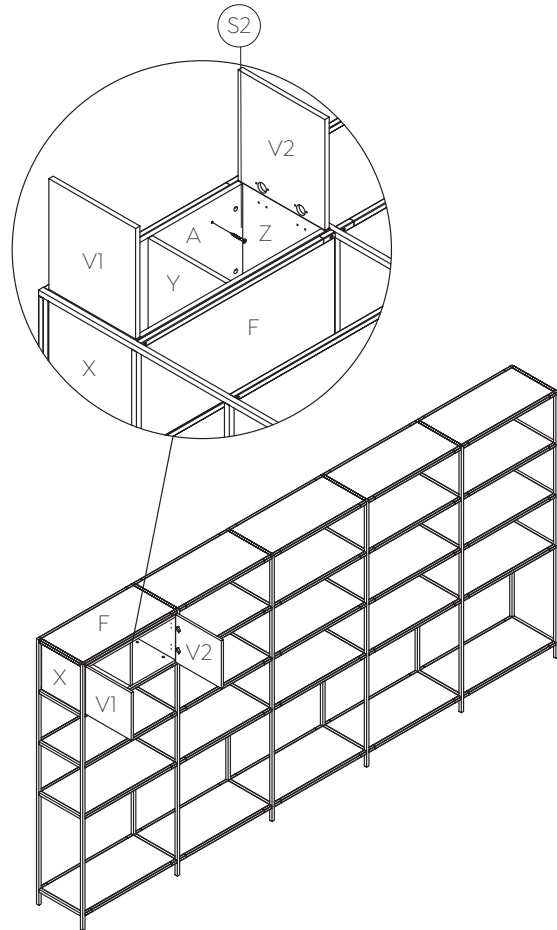

1. Put the cabinet on the shelf.
2. Fix the cabinet on top of shelf using screws S2.

Complete:

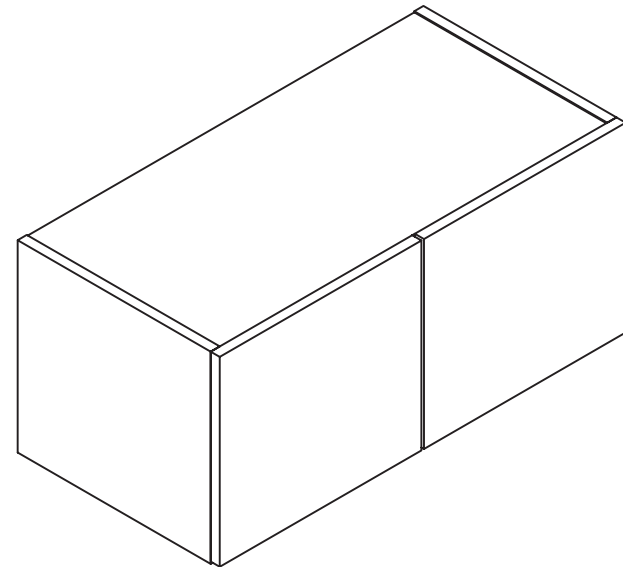

Remove all QC and panel labels and wipe clean using a damp cloth and general household cleaner.



Sydney 02 8188 2732

Melbourne 03 9111 0315

Brisbane 07 3733 1923

Adelaide 08 7111 0810

Perth 08 9468 2707

info@olgoffice.com

myolg.online | olgoffice.com | officedesigner.net | motionoffice.com