

---

## Rhodes Modular Shelving (50-MSCUBB8070)

Assembly Instructions

# Rhodes Modular Shelving (50-MSCUBB8070)

## Components List

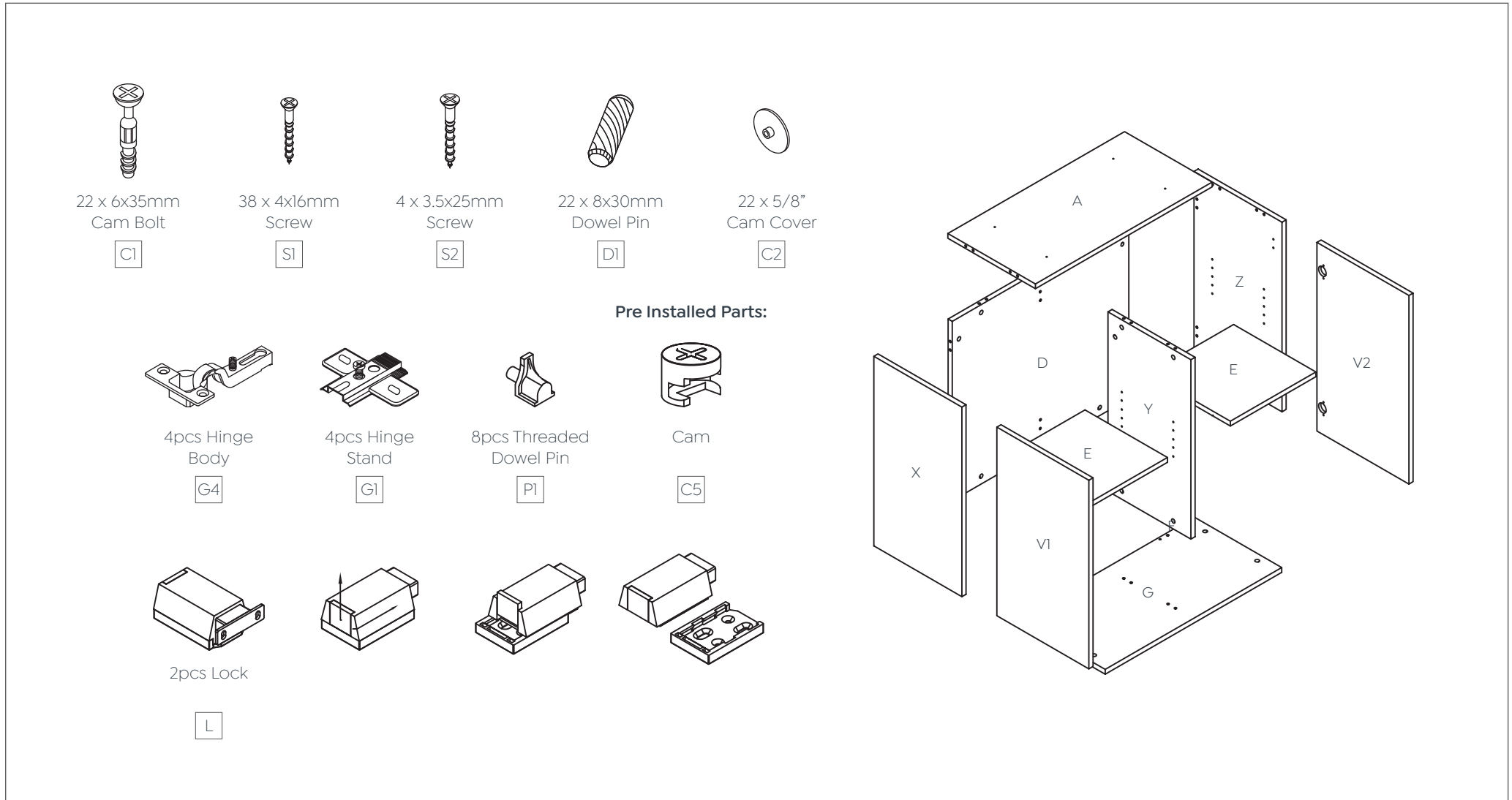

## STEP 1:

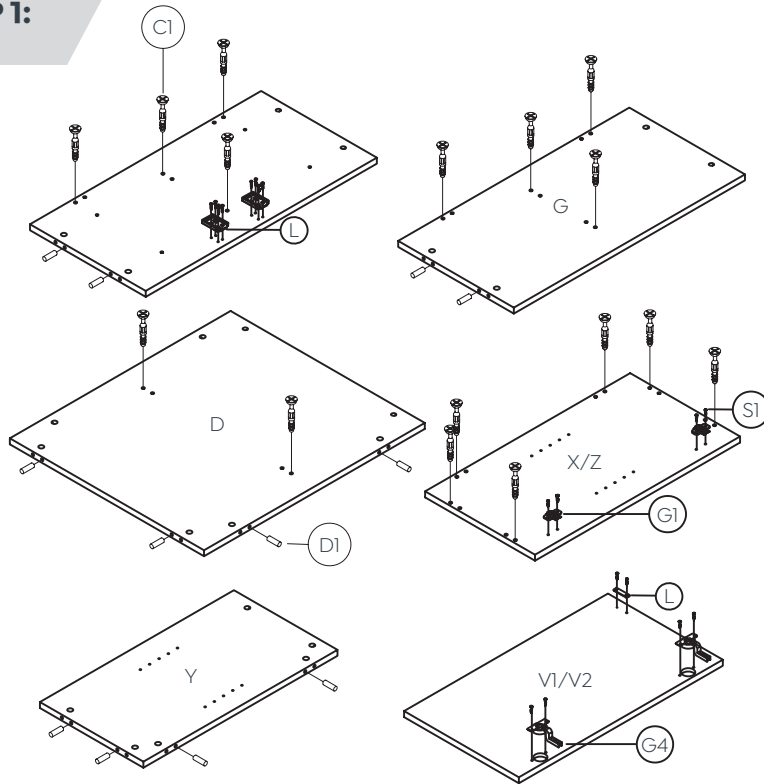

### Preparation for panels A, G, X, Z, D, Y, V1 and V2.

1. Insert cam bolts C1 into panels A, G, D, X and Z as illustrated above.
2. Insert dowel pins D1 into panels A, G, D and Y as illustrated above.
3. Fix hinge stands G1 to panels X, Z with screws S1 as illustrated above.
4. Fix hinge body G4 to panels V1, V2 with screws S1 as illustrated above.
5. Locate the trim ring on lock and set aside. Insert cylinder of lock L through hole in A and secure with S1 screws. Add trim ring to lock on outside of V1, V2.

## STEP 2:

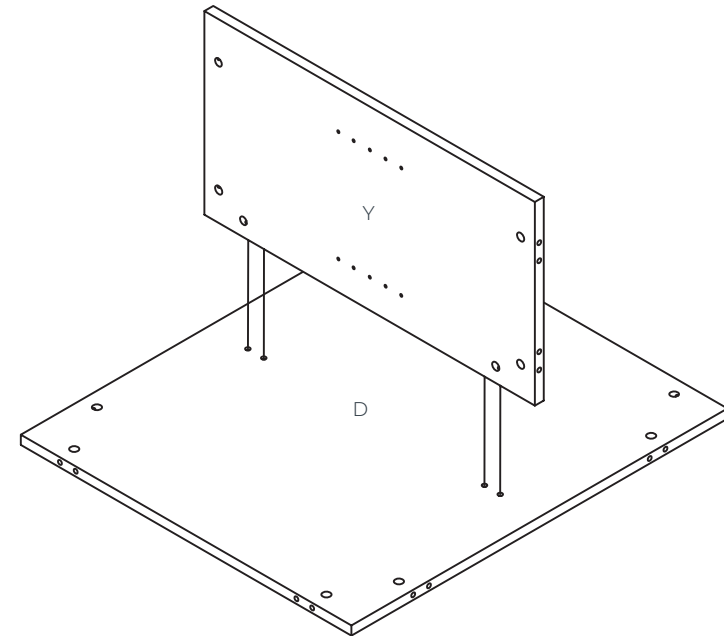

### Panel Y and D assembly.

1. Insert cam bolts C1 and dowel pins D1 on panel Y into cams on panel D and tighten in a clockwise direction as illustrated above.

# Rhodes Modular Shelving (50-MSCUBB8070)

## Assembly Instructions

### STEP 3:

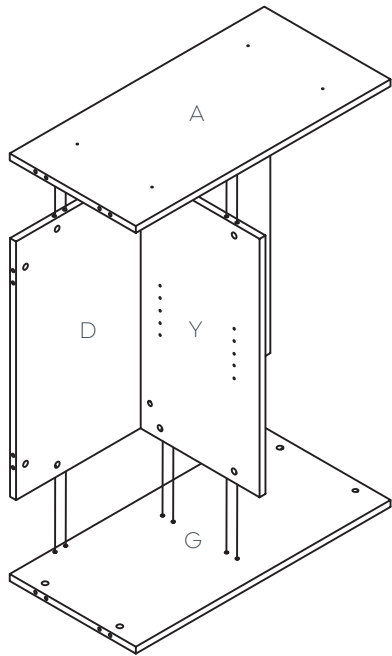

#### Panel A and G assembly.

1. Insert cam bolts C1 and dowel pins D1 on panel A, G into cams on panel Y, D and tighten in a clockwise direction as illustrated above.

### STEP 4:

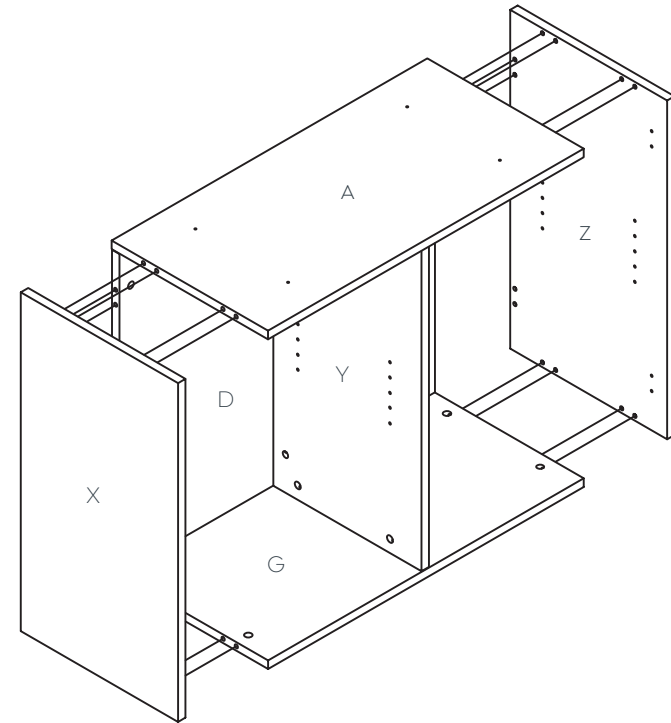

#### Panels Y and D assembly.

1. Insert cam bolts C1 on panel X and Z into cams on panels A, D, G and tighten in a clockwise direction as illustrated above.

## STEP 5:

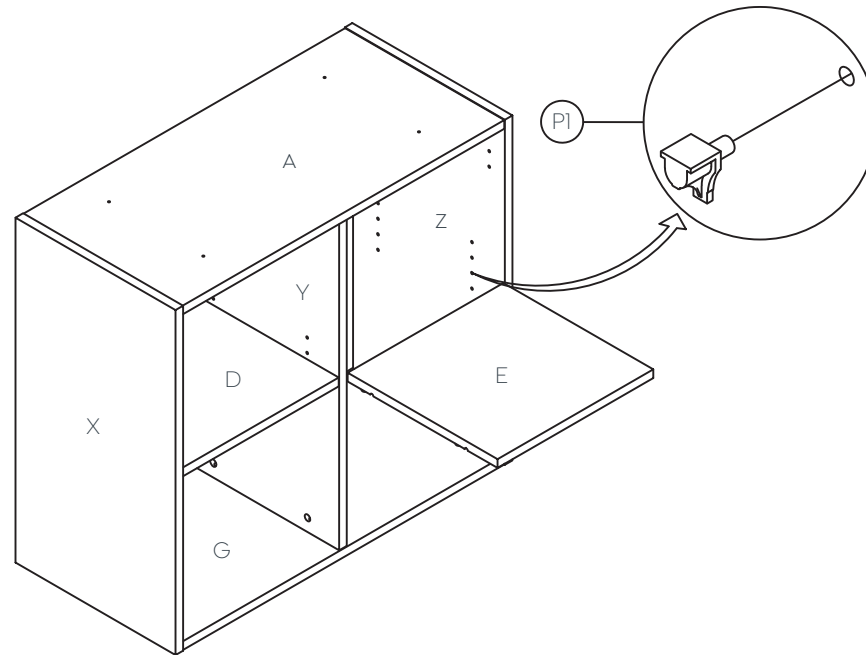

### Moveable shelf E assembly.

1. Insert threaded dowel pins P1 into panels X, Y and Z as illustrated above.
2. Put the panel E on the top of threaded dowel pins P1 as illustrated above.

# Rhodes Modular Shelving (50-MSCUBB8070)

## Assembly Instructions

### STEP 6:

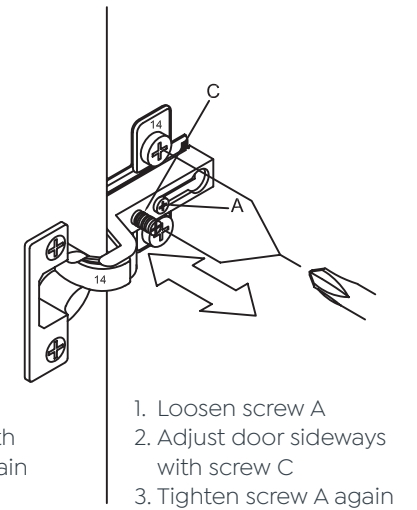
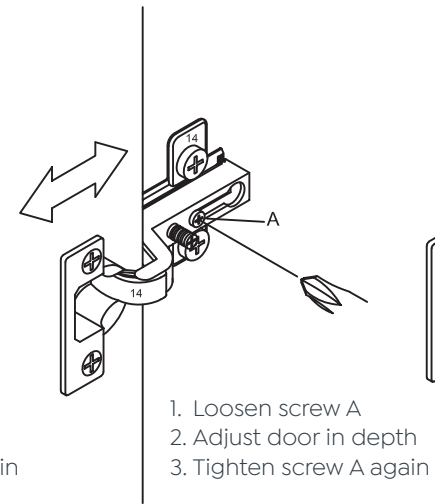
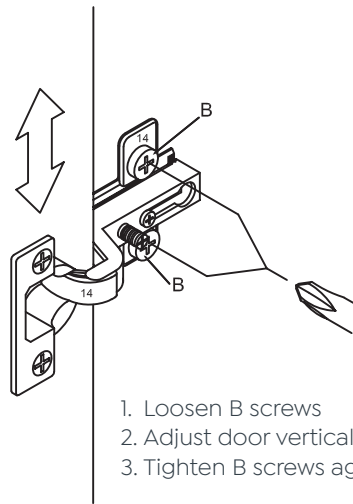
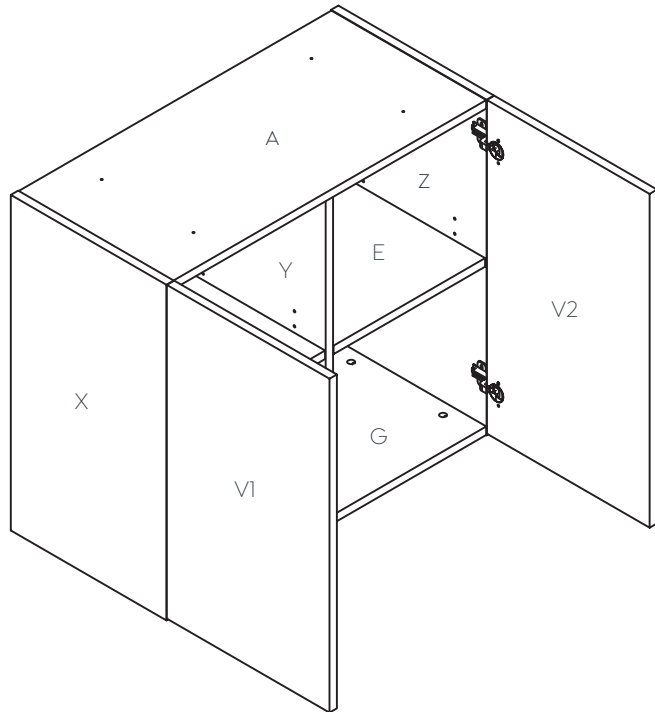

## STEP 7:

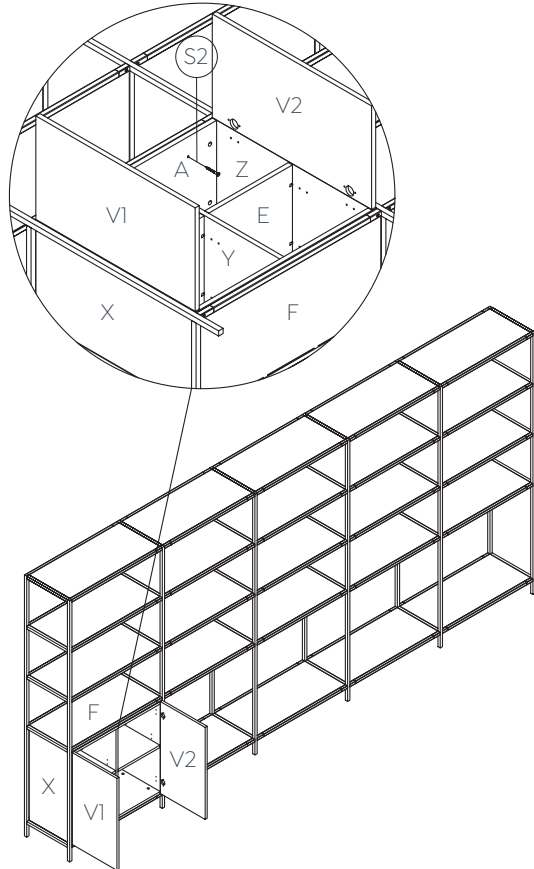

1. Put the cabinet on the shelf.
2. Fix the cabinet on top of shelf using screws S2.

## Complete:

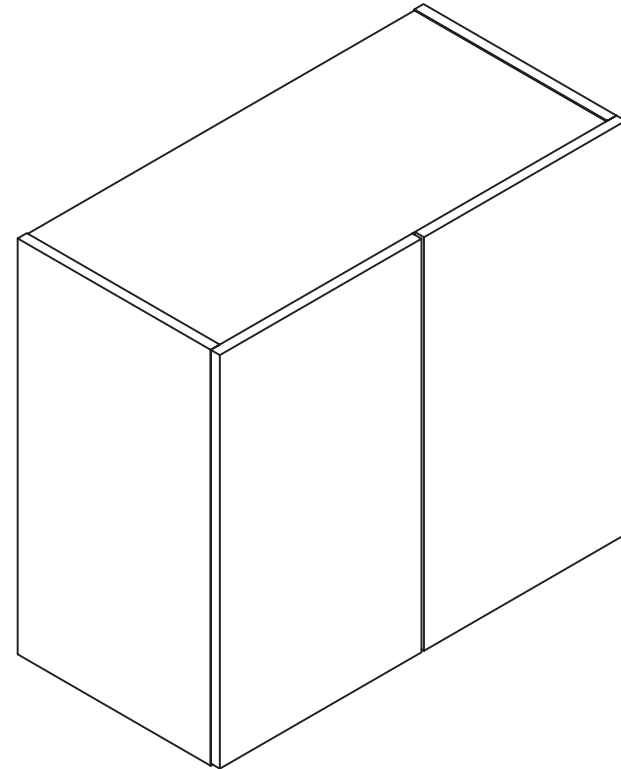

Remove all QC and panel labels and wipe clean using a damp cloth and general household cleaner.



**Sydney** 02 8188 2732

**Melbourne** 03 9111 0315

**Brisbane** 07 3733 1923

**Adelaide** 08 7111 0810

**Perth** 08 9468 2707

[info@olgoffice.com](mailto:info@olgoffice.com)

[myolg.online](https://myolg.online) | [olgoffice.com](https://olgoffice.com) | [officedesigner.net](https://officedesigner.net) | [motionoffice.com](https://motionoffice.com)